

HIGH STRENGTH ALLOY SHACKLES

HEAT-TREATED, DROP FORGED ALLOY STEEL
ANCHOR AND CHAIN SHACKLES: SCREW PIN
AND SAFETY BOLT PIN

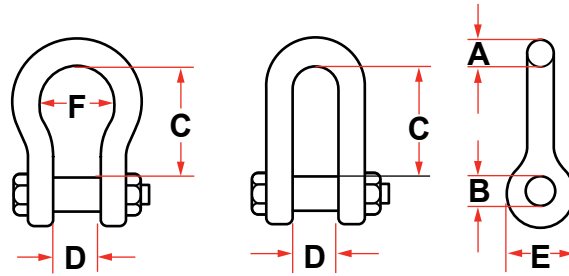

RATED LOAD TONS	DIMENSIONS IN INCHES							WEIGHT IN POUNDS	
	A	B	C		D	E	F	SCREW PIN OR ROUND PIN	SAFETY BOLT
			ANCHOR	CHAIN					
1-1/4	3/8	7/16	1-7/16		21/32	31/32	1-1/32	0.3	
1-3/4	7/16	1/2	1-11/16		23/32	1-1/16	1-5/32	0.5	
2-1/2	1/2	5/8	1-7/8		13/16	1-3/16	1-5/16	0.75	0.84
4	5/8	3/4	2-3/8		1-1/16	1-9/16	1-11/16	1.3	1.8
6	3/4	7/8	2-13/16		1-1/4	1-7/8	2	2.3	2.5
7-1/2	7/8	1	3-5/16		1-7/16	2-1/8	1-9/32	3.5	4.0
10	1	1-1/8	3-3/4		1-11/16	2-3/8	2-11/16	5.0	5.5
11-1/2	1-1/8	1-1/4	4-1/4		1-13/16	2-5/8	2-29/32	7.0	7.5
14	1-1/4	1-3/8	4-1/2		2-1/32	3	3-1/4	9.5	11.0
16	1-3/8	1-1/2	5-1/4		2-1/4	3-5/16	3-1/2	13.0	14.0
20*	1-1/2	1-5/8	3-3/4		2-3/8	3-5/8	3-7/8	17.0	19.0
30	1-1/2	1-5/8	5-3/4	5	2-3/8	3-5/8	3-7/8	19.0	21.0
24*	1-5/8	1-3/4	6-1/4		2-5/8	3-13/16	4-3/8	24.0	26.0
30*	1-3/4	2	7		2-7/8	4-5/16	5	28.0	31.0
40	1-3/4	2	7	5-3/4	2-7/8	4-5/16	5	30.0	34.0
40*	2	2-1/4	7-3/4		3-1/4	5	5-3/4	39.0	42.0
50	2	2-1/4	7-3/4	6-3/4	3-1/4	5	5-3/4	48.0	52.0
60	2-1/4	2-1/2	8-3/4	7-1/8	3-7/8	5-1/2	6-1/2		68.0
80	2-1/2	2-3/4	10-1/2		4-1/8	6	7-1/4		92.0
85*	2-1/2	2-3/4	10	8	4-1/8	6	7-1/4		94.0
95	2-3/4	3	11-1/4	8-1/2	4-1/2	6-1/4	8		121.0
110	3	3-1/4	13	9	5	6-3/4	9		144.0
120*	3	3-1/4	13		5	6-1/2	9		146.0
140	3-1/2	3-3/4	15	10-1/2	5-3/4	8-1/2	10-1/8		250.0
175	4	4-1/4	17	12	6-1/2	9-3/8	10-1/2		360.0
250	4-1/2	4-3/4	19	14-1/2	7-1/4	10	12-1/2		445.0
250*	4-3/4	5-1/8	22-1/2		7-7/8	10-1/2	14-1/8		640.0
300	5	5-1/4	21	21	8	12-1/2	14		620.0
300*	5-1/8	5-3/4	25-1/2		8-1/4	11	15-3/4		810.0
350	5-1/2	5-3/4	2-3	23	8-3/4	13-1/2	15-1/2		990.0
400*	5-3/4	6-1/8	28		8-7/8	12-1/2	17-3/4		1140.0
400	6	6-3/4	26	26	10-1/4	15	17-1/2		1225.0
500*	6-1/8	6-3/4	30-1/2		9-7/8	14	19-5/8		1380.0
500	6-1/2	7-1/4	29	29	11	16	19		1710.0
600	7	7-1/2	31	31	11-1/2	17	20		2030.0
700	7-1/2	8	33	33	12-1/4	18	21-1/2		2605.0
750*	8	8-1/2	32-1/2		13-3/8	17	23		3070.0
800	8	8-1/2	36	36	13-1/2	19	23		2980.0
1000*	9-1/2	10	39		15-1/2	20	29-1/8		5150.0

* Available Size Options

** Various Dimensional Options are available:
Please confirm when necessary.
Sizes 3/16" Thur 1" Available in Stainless Steel

NOTES: Minimum breaking strength is five times rated working load. Furnished in galvanized or self colored finish. Pins are galvanized after threading. Shackles can be furnished with complete traceability, proof test certificates, and serial number at slight additional charge.