

EYE HOOK (ROV)

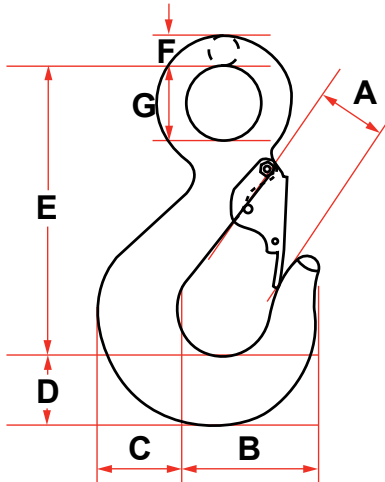

STANDARD HOOK WITH SAFETY LATCH

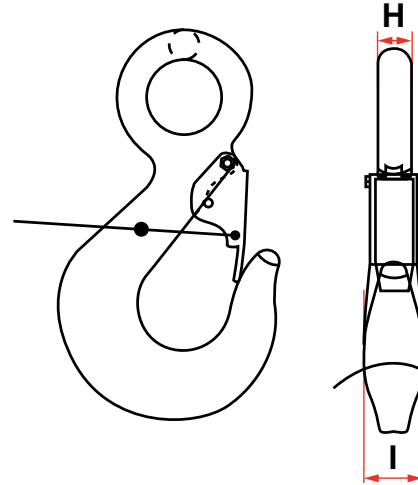

ROV HOOK

HOOK NO.	SWL (TONS)	MBL (TONS)	DIMENSIONS IN MM									WEIGHT KG
			A	B	C	D	E	F	G	H	I	
27	8	32	2-1/8	2-11/16	2-3/32	1-7/8	8	1	1-31/32	1	1-1/2	8.2
29	12.5	50	2-13/16	3-3/8	2-11/16	2-13/32	9-31/32	1-1/4	2-1/2	1-1/4	1-7/8	17
30	16	64	3-3/16	3-25/32	3	2-11/16	11-3/16	1-13/32	2-27/32	1-13/32	2-3/32	22
31	20	80	3-19/32	4-7/32	3-3/8	3	12-9/16	1-9/16	3-3/16	1-9/16	2-13/32	29
32	28	112	2-13/16	4-13/32	3-25/32	3-1/4	13-15/16	1-1/2	3-3/4	1-1/2	2-15/32	37
33	31	125	3-3/16	4-15/16	4-3/16	3-5/8	15-5/16	1-11/16	3-15/16	1-11/16	2-3/4	51
34	40	160	3-21/32	5-1/2	4-9/16	4-1/16	18	1-7/8	5-1/8	1-7/8	3-5/32	75
35	50	200	4-3/16	6-7/32	5-5/16	4-9/16	19-1/2	2-1/8	5-1/8	2-1/8	3-1/2	108
36	63	250	4-11/16	6-15/16	5-15/16	5-1/8	22-1/4	2-3/8	5-29/32	2-3/8	3-29/32	139
37	80	320	5-5/32	7-13/16	6-5/8	5-23/32	27-5/32	2-5/8	6-11/16	2-5/8	4-5/16	218
38	100	400	5-15/16	8-7/8	7-11/16	6-25/32	28-9/16	3-1/8	6-7/8	3-1/8	4-15/16	353
39	150	600	6-13/16	9-27/32	8-7/8	7-27/32	30-1/8	3-3/8	5-1/8	3-3/8	6-5/16	573
40	200	800	7-7/8	10-13/16	10-1/4	9-5/16	33-15/32	4	5-29/32	4	7-3/32	919
41	250	1000	9-3/16	12-3/16	11-13/32	10-19/32	36-17/32	4-23/32	6-11/16	4-23/32	7-7/8	1270
42	300	1200	10-3/8	13-25/32	13	12-3/16	41-13/32	5-1/2	7-15/32	5-1/2	8-21/32	1808
43	400	1600	11-15/16	15-3/4	14-31/32	13-9/16	47-1/16	6-11/16	8-1/4	6-11/16	9-7/16	2480
44	500	2000	14-9/16	17-23/32	16-1/8	15-11/32	53-9/16	7-7/8	8-15/32	7-7/8	12-19/32	4057

Material : Grade 80
 Safety : 4 times
 Finish : Painted
 Certificate : Manufacturer certificate, proofload on request.

CHAIN HOOKS

EYE GRAB HOOK

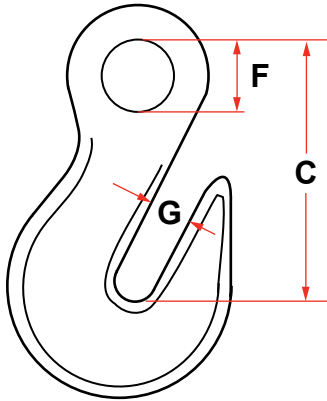

SIZE OF CHAIN (INCHES)	RATED LOAD (LBS.)			APPROXIMATE DIMENSIONS (INCHES)			WEIGHT POUNDS EACH
	LOW CARBON	HIGH TEST	LOW ALLOY	C	F	G	
1/4	1250	2600	3250	1-31/32	1/2	11/32	0.28
5/16	1900	3900	5000	2-1/4	9/16	7/16	0.45
3/8	2650	5400	6600	2-9/16	21/32	1/2	0.79
7/16	3500	7200	8750	2-15/16	3/4	9/16	1.19
1/2	4500	9200	11250	3-3/8	7/8	21/32	1.75
5/8	6900	11500	16500	4-3/32	1-1/16	25/32	3.25
3/4		18500	27000	5-5/32	1-3/8	15/16	5.94
7/8		24000	35000	5-29/32	1-9/16	1-1/16	9.17
1		30000	45000	6-23/32	1-13/16	1-3/16	13.83

EYE SLIP HOOK

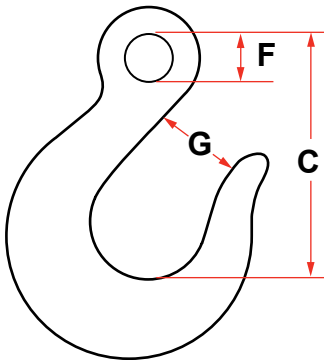

SIZE OF CHAIN (INCHES)	RATED LOAD (LBS.)			APPROXIMATE DIMENSIONS (INCHES)			WEIGHT POUNDS EACH
	LOW CARBON	HIGH TEST	LOW ALLOY	C	F	G	
1/4	1250	2600	3250	2-17/32	1/2	15/16	0.40
5/16	1900	3900	5000	2-29/32	5/8	1-1/16	0.70
3/8	2650	5400	6600	3-5/16	23/32	1-5/16	1.00
7/16	3500	7200	8750	3-7/8	13/16	1-9/16	1.56
1/2	4500	9000	11250	4-9/32	15/16	1-11/16	2.31
5/8	6900	10000	15000	5-7/32	1-1/8	2	3.78
3/4		12500	19250	5-25/32	1-3/8	2-1/8	6.56
7/8		17250	26000	7-5/32	1-9/16	2-3/4	10.42
1		22700	34000	8-3/32	1-13/16	3	14.33

RATED LOAD SHOULD NOT BE EXCEEDED

CHAIN HOOKS

CLEVIS GRAB HOOK

SIZE OF CHAIN	RATED LOAD POUNDS			APPROXIMATE DIMENSIONS (INCHES)				WEIGHT POUNDS EACH
	HIGH TEST	TRANSPORT	LOW ALLOY	C	E	F	G	
1/4	2600	3150	3600	1-13/16	7/16	3/8	11/32	0.36
5/16	3900	4700	5400	2-5/32	1/2	7/16	7/16	0.60
3/8	5400	6600	7500	2-15/32	19/32	15/32	1/2	1.00
7/16	7200	8750	10000	2-25/32	21/32	9/16	9/16	1.31
1/2	9200	11300	12750	3-7/32	3/4	5/8	21/32	2.06
5/8	12750	16500	19000	4-3/32	29/32	3/4	25/32	4.25
3/4	18500		27000	4-5/8	15/16	7/8	15/16	7.19

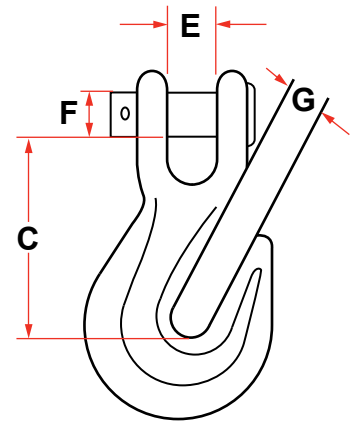

CLEVIS SLIP HOOK

SIZE OF CHAIN	RATED LOAD POUNDS			APPROXIMATE DIMENSIONS (INCHES)				WEIGHT POUNDS EACH
	HIGH TEST	TRANSPORT	LOW ALLOY	C	E	F	G	
1/4	2600	3150	3250	2-9/16	7/16	3/8	15/16	0.44
5/16	3900	4700	5000	2-23/32	13/32	7/16	1-1/16	0.75
3/8	5400	6000	6600	3-1/4	19/32	15/32	1-5/16	1.13
7/16	7200	8700	8750	3-21/32	9/16	9/16	1-9/16	2.06
1/2	9200	11000	11300	4	3/4	5/8	1-11/16	2.75
5/8	11500	16000	16500	4-15/16	13/16	3/4	2	4.75
3/4			19250	6-3/32	1-5/16	1	2-1/2	11.28

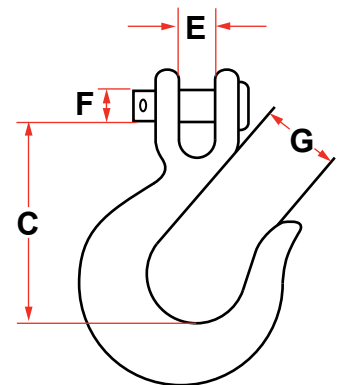

RATED LOAD SHOULD NOT BE EXCEEDED