

INTRODUCTION



SHACKLES



SHACKLES

Application information

Shackles are used in lifting and static systems as removable links to connect (steel) wire rope, chain and other fittings.

Chain or Dee shackles (H9, D15, H11 and D10 shackles) are mainly used on one-leg systems.

Anchor, Bow or Wide body shackles (H9, H10 and H14 shackles) are used on one leg and multi-leg systems.

End-Joining, Joining and Anchor shackles (D14, D16 and D17 shackles) are used in mooring or anchor lines.

Instructions for use

For screw pins ensure that the pin is correctly screwed into the shackle eye, i.e. tighten hand-tight, then secure using a wrench or other suitable tool so that the collar of the pin is fully seated on the shackle eye. Incorrect seating of the pin may be due to a bent pin, too tight fitting thread or misalignment of the pin holes. Do not use the shackle under these circumstances. Never replace a shackle pin except with one of the same size, type and make as it may not be suitable for the loads imposed.

Select the correct type of shackle and its Working Load Limit for the particular application. Should extreme circumstances or shock loading be applicable, this must be well taken into account on selecting the correct shackle. Make sure that the shackle is supporting the load correctly, i.e. along the axis of the shackle body centre line, avoid introduction of bending loads, unstable loads and do not apply overloads. To avoid eccentric loading of the shackle a loose spacer may be used on either end of the shackle pin.

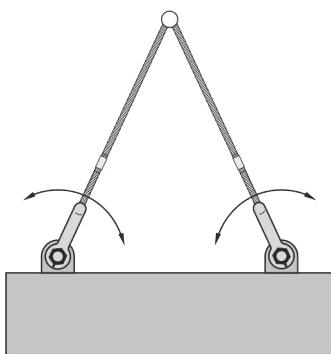

Right

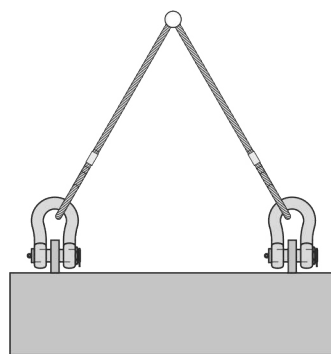

Wrong

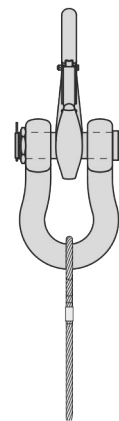

Right

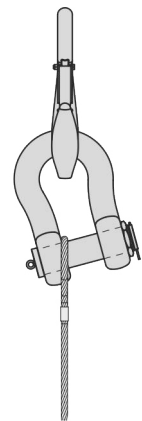

Wrong

SHACKLES

Avoid applications where due to movement (e.g. of the load or the rope) the shackle pin can rotate and possibly be unscrewed. If such an application is necessary or when the shackle is to be left in place for a prolonged period or where maximum pin security is required, use a shackle with a safety bolt, nut and pin cotter pin.

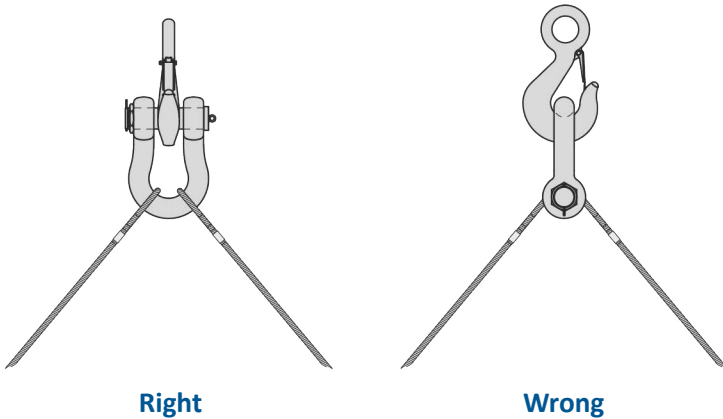

Loads

Point loads: Most of the time the load bearing component that is in connection with a shackle is of a rounded shape. Point loading of shackles is allowed but the minimum diameter of a rounded component should be equal or bigger than the bow size of the shackle being used. Bigger diameters and/or flat parts (at shackle pin side) to increase contact area can be beneficial. Sharp edges should be avoided.

Side loads: Side loads should be avoided as well, as the products are not designed for this purpose. If side loads cannot be avoided, the reduction factors from below table must be taken into account: In-line loading is considered to be a load perpendicular to the pin and in the plane of the bow. Load angles in the table are the deviating angles from the in line loads.

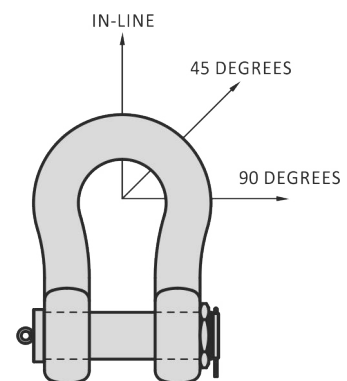

Angle of Side Load from vertical in-line of shackle	Reduction for side loading New Working Load Limit
0° In-Line	100% of Rated Working Load Limit
45° from In-Line	70% of Rated Working Load Limit
90° from In-Line	50% of Rated Working Load Limit

When using shackles in connection with multi-leg slings, due consideration should be given to the effect of the angle between the legs of the sling. As the angle increases, so does the load in the sling leg and consequently in any shackle attached to that leg. When a shackle is used to connect two slings to the hook of a lifting device, a bow type shackle must be assembled with the slings in the shackle body and the hook engaged with the shackle pin. The angle between the slings should not exceed 120°. If symmetrically loaded the shackle may be used to the full WLL.

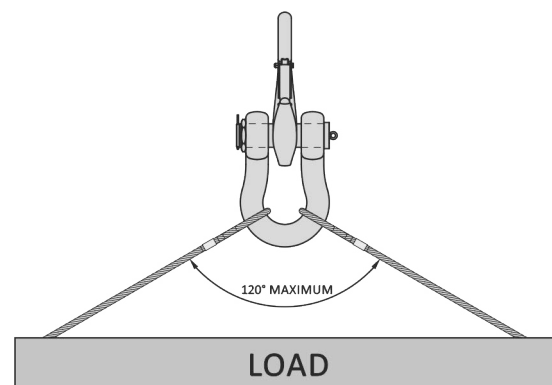

SHACKLES

Shackle-to-shackle connection

GN shackles can also be used according to below configurations. The maximum load of the configuration is limited by the component with the lowest WLL.

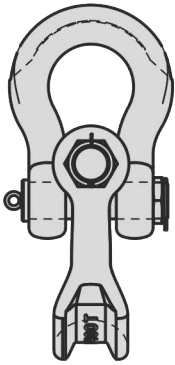

Pin - Pin

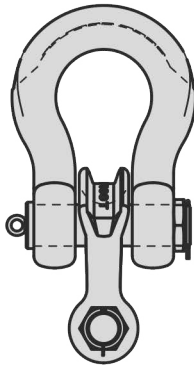

Bow - Pin

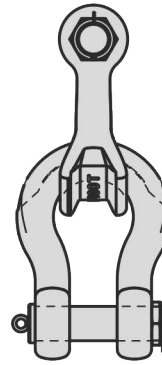

Bow - Bow

Temperatures

If extreme temperature situations are applicable, the following load reduction must be taken into account:

Temperature	Reduction for elevated temperatures New Working Load Limit
up to 200°C	100% of Rated Working Load Limit
200°C - 300°C	70% of Rated Working Load Limit
300°C - 400°C	50% of Rated Working Load Limit
> 400°C	not allowed

On request we can inform you about low temperature impact values, -20, -40 and -50 degrees Celsius.

Inspection

Inspection should take place at least every six months and even more frequently when the shackles are used in severe operating conditions.

Shackles should be inspected before use to ensure that:

- All markings are legible
- The body and pin are both identifiable as being of the same size, type and make
- The threads of the pin and the body are undamaged
- Never use a safety bolt type shackle without using a securing pin
- The body and the pin are not distorted or unduly worn
- The body and pin are free from nicks, gouges, cracks and corrosion
- Shackles may not be heat treated as this may affect their Working Load Limit
- Never modify, repair or reshape a shackle by machining, heating or bending as this will affect the Working Load Limit
- Welding on shackles body and pins is not allowed, with exception of the crown pin shackles D10

Markings

As minimum the following markings must be hard stamped in the shackle:

- Applicable Working load or Proof load
- Brand mark
- Production number

Material : Alloy steel
 Safety factor : 5 times
 Standards : Generally according to US Federal Spec RR-C-271
 Finish : Painted
 Temperature range : -40°F up to +392°F, Polar Rated
 Standard certification : Certificate of Conformity
 3.1 material certificate EN 10204

Non-standard sizes or custom products available on request

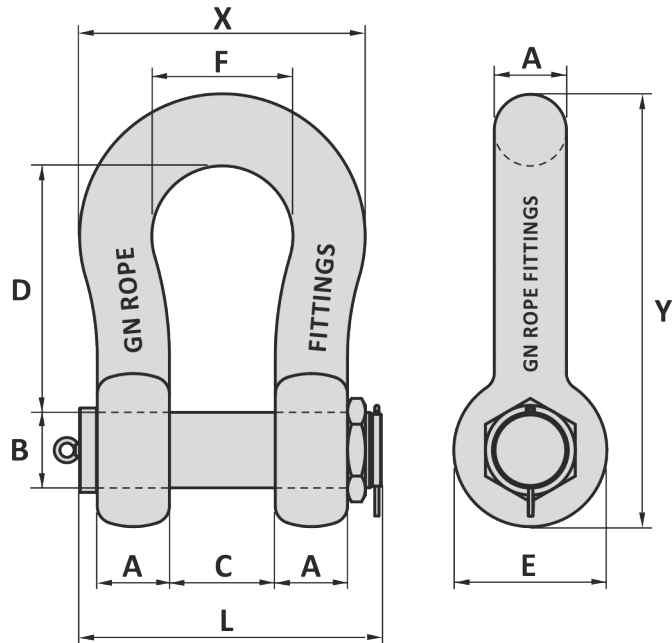
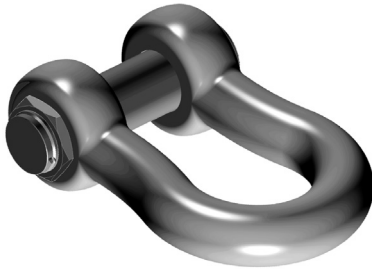

* Shackles from WLL 1250 ton completed with eyebolts on both sides

Art. No.	WLL ton	A inch	B inch	C inch	D inch	E inch	F inch	L inch	X inch	Y inch	Weight lbs
37001209	120	3 1/2	3 3/4	5 29/32	14 31/32	7 7/8	9 3/8	16 17/32	16 3/8	24 9/32	243
37001509	150	4	4 1/4	6 11/16	15 3/4	9 1/16	10 13/16	18 11/16	18 7/8	26 13/32	353
37002009	200	4 23/32	4 15/16	7 3/32	19 11/16	10 1/4	11 13/32	20 15/32	20 7/8	32	518
37002509	250	4 15/16	5 1/2	8 1/16	21 1/4	10 1/4	12	22 1/16	21 27/32	34 1/16	628
37003009	300	5 1/8	5 23/32	8 1/16	23 5/8	12	12	22 1/16	22 1/4	37 23/32	750
37004009	400	6 1/2	6 7/8	9 1/16	26 25/32	13 25/32	12 13/16	26 3/16	25 25/32	43 3/8	1312
37005009	500	7 3/32	7 7/32	10 1/32	27 7/16	14 7/16	13 25/32	28 11/32	27 15/16	45 19/32	1510
37006009	600	7 11/16	8 1/16	11 1/32	27 7/16	15 15/16	14 3/4	32 3/32	30 7/8	47 1/4	1940
37007009	700	8 1/16	8 9/16	12 3/16	27 7/16	17 1/8	15 3/4	33 7/8	31 7/8	48 15/32	2161
37008009	800	8 1/4	8 9/16	12 3/16	27 7/16	17 1/8	15 3/4	34 1/4	32 9/32	48 21/32	2425
37009009	900	8 21/32	9 1/16	13	27 7/16	18 5/16	16 17/32	35 13/16	33 7/8	49 15/16	2822
37010009	1000	9 1/16	9 7/16	13 25/32	29 17/32	18 29/32	16 17/32	37 13/32	34 21/32	50 25/32	3219
37012509	1250	10 15/16	10 3/8	14 7/16	30 23/32	23 3/32	17 23/32	43 1/2	39 3/4	58 23/32	5115
37015009	1500	11 1/32	11 13/32	14 7/16	31 1/2	24	17 23/32	43 1/2	39 3/4	60 1/4	5401
37017509	1750	11 13/16	13	16 15/16	37 13/32	26	21 1/4	48 7/16	44 7/8	68 11/16	7231
37020009	2000	12 19/32	14 3/16	18 1/8	41 11/32	26 25/32	22 1/16	51 3/16	47 1/4	74 13/32	8642

Tolerance: Inside length ± 7.5%, all other forged parts ± 5%, machined parts ± 1/32 inch

29-06-2021

Material : Alloy steel
 Safety factor : 5 times
 Standards : Generally according to US Federal Spec RR-C-271
 Finish : Painted
 Temperature range : -40°C up to +200°C, Polar Rated
 Standard certification : Certificate of Conformity
 3.1 material certificate EN 10204

Non-standard sizes or custom products available on request

GENERAL

SHACKLES

THIMBLES

SOCKETS

LINKS

SWIVELS

HOOKS

MOORING

OTHERS

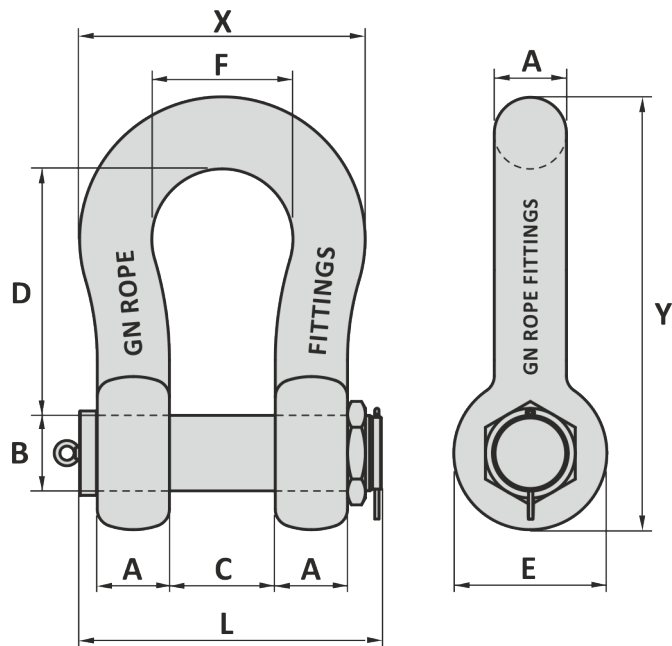
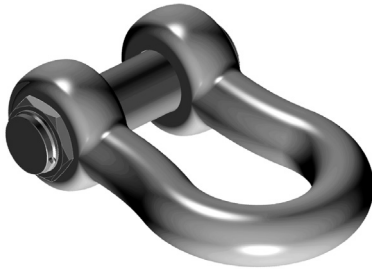

* Shackles from WLL 1250 ton completed with eyebolts on both sides

Art. No.	WLL ton	A mm	B mm	C mm	D mm	E mm	F mm	L mm	X mm	Y mm	Weight kg
37001209	120	89	95	150	380	200	238	420	416	617	110
37001509	150	102	108	170	400	230	275	475	479	671	160
37002009	200	120	125	180	500	260	290	520	530	813	235
37002509	250	125	140	205	540	260	305	560	555	865	285
37003009	300	130	150	205	600	305	305	570	565	958	340
37004009	400	165	175	230	680	350	325	665	655	1108	595
37005009	500	180	185	255	700	370	350	720	710	1158	685
37006009	600	195	205	285	700	405	375	815	765	1200	880
37007009	700	205	217	310	700	435	400	860	810	1231	980
37008009	800	210	217	310	700	435	400	870	820	1236	1100
37009009	900	220	230	330	700	465	420	910	860	1268	1280
37010009	1000	230	240	350	750	480	420	950	880	1290	1460
37012509	1250	278	270	370	780	590	450	1105	1010	1490	2320
37015009	1500	280	290	370	800	610	450	1105	1010	1530	2450
37017509	1750	300	330	430	950	660	540	1230	1140	1745	3280
37020009	2000	320	360	460	1050	680	560	1300	1200	1890	3920

Tolerance: Inside length $\pm 7.5\%$, all other forged parts $\pm 5\%$, machined parts $\pm 1\text{ mm}$

29-06-2021

Material : Alloy steel
 Safety factor : 5 times
 Finish : ≤ 55 ton galvanized
 > 55 ton painted
 Temperature range : ≤ 55 ton -20°C up to +200°C
 > 55 ton -40°C up to +200°C, Polar Rated
 Standard certification : Certificate of Conformity
 3.1 material certificate EN 10204
 ≤ 300 ton Type Approved Product

Non-standard sizes or custom products available on request

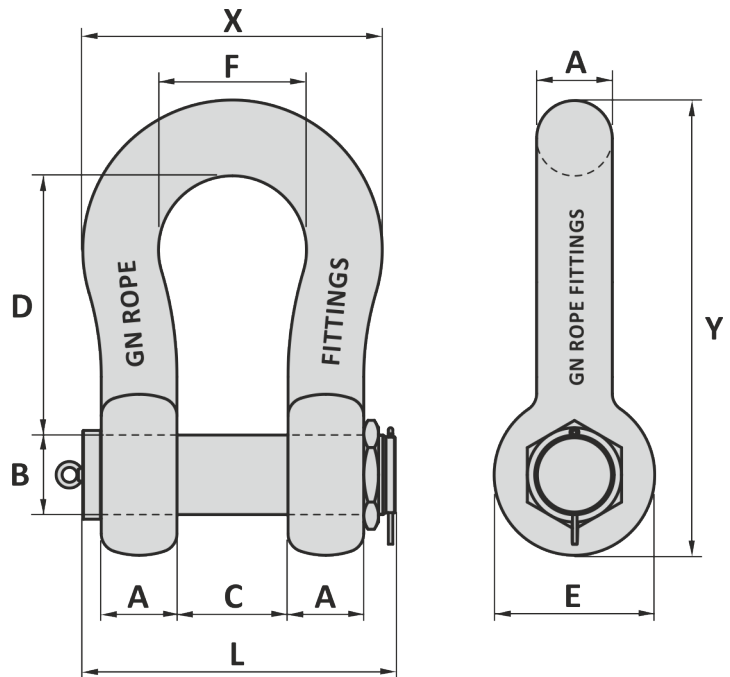
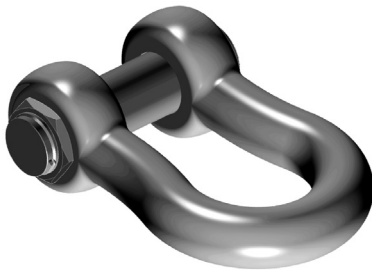

* Shackles from WLL 30 ≤ 120 ton are not supplied with an eyebolt

Art. No.	WLL ton	A mm	B mm	C mm	D mm	E mm	F mm	L mm	X mm	Y mm	Weight kg
38000259	30	38	42	60	146	88	99	202	175	249	8.4
38000400	40	45	50	74	178	103	126	249	216	300	15
38000550	55	57	57	83	197	117	138	286	252	341	22
37000855	85	70	70	105	260	143	180	344	320	437	42
37001105	120	80	83	127	329	162	190	372	350	532	70
37001409	150	90	95	135	380	200	240	405	420	613	110
37001759	175	102	108	140	400	230	250	440	450	669	150
37002008	200	120	121	180	500	260	290	525	530	811	225
37002508	250	125	127	220	520	260	325	575	575	839	300
37003008	300	135	152	220	500	305	330	605	610	869	352
37004008	400	165	178	220	572	350	330	655	655	1001	537

Tolerance: Inside length ± 7.5%, all other forged parts ± 5%, machined parts ± 1 mm

Art. No.	WLL ton	A inch	B inch	C inch	D inch	E inch	F inch	L inch	X inch	Y inch	Weight lbs
38000259	30	1 1/2	1 7/32	2 3/8	5 3/4	3 15/32	3 29/32	7 15/16	6 7/8	9 13/16	19
38000400	40	1 25/32	1 31/32	2 29/32	7	4 1/16	4 3/32	9 13/16	8 1/2	11 13/16	33
38000550	55	2 1/4	2 1/4	3 1/4	7 3/4	4 5/8	5 7/16	11 1/4	9 15/16	13 7/16	49
37000855	85	2 3/4	2 3/4	4 1/8	10 1/4	5 5/8	7 3/32	13 9/16	12 19/32	17 3/16	93
37001105	120	3 3/32	3 1/4	5	12 15/16	6 3/8	7 15/32	14 21/32	13 25/32	20 15/16	154
37001409	150	3 9/16	3 3/4	5 5/16	14 31/32	7 7/8	9 1/16	15 15/16	16 17/32	24 1/8	243
37001759	175	4	4 1/4	5 1/2	15 3/4	9 1/16	9 27/32	17 5/16	17 23/32	26 11/32	331
37002008	200	4 23/32	4 3/4	7 3/32	19 1/16	10 1/4	11 13/32	20 11/16	20 7/8	31 15/16	496
37002508	250	4 15/16	5	8 21/32	20 15/32	10 1/4	12 13/16	22 5/8	22 5/8	33 1/32	661
37003008	300	5 5/16	6	8 21/32	19 1/16	12	13	23 13/16	24	34 7/32	776
37004008	400	6 1/2	7	8 21/32	22 1/16	13 25/32	13	25 25/32	25 25/32	39 13/32	1184

Tolerance: Inside length ± 7.5%, all other forged parts ± 5%, machined parts ± 1/32 inch

08-05-2018

GENERAL
SHACKLES
THIMBLES
SOCKETS
LINKS
SWIVELS
HOOKS
MOORING
OTHERS

Material : Alloy steel
 Safety factor : ≤ 2000 ton 5 times
 > 2000 ≤ 3000 ton 4,5 times
 > 3000 ton 4 times
 Finish : Painted
 Temperature range : ≤ 40 ton -4°F up to +392°F
 > 40 ton -40°F up to +392°F, Polar Rated
 Standard certification : Certificate of Conformity
 3.1 material certificate EN 10204

Non-standard sizes or custom products available on request

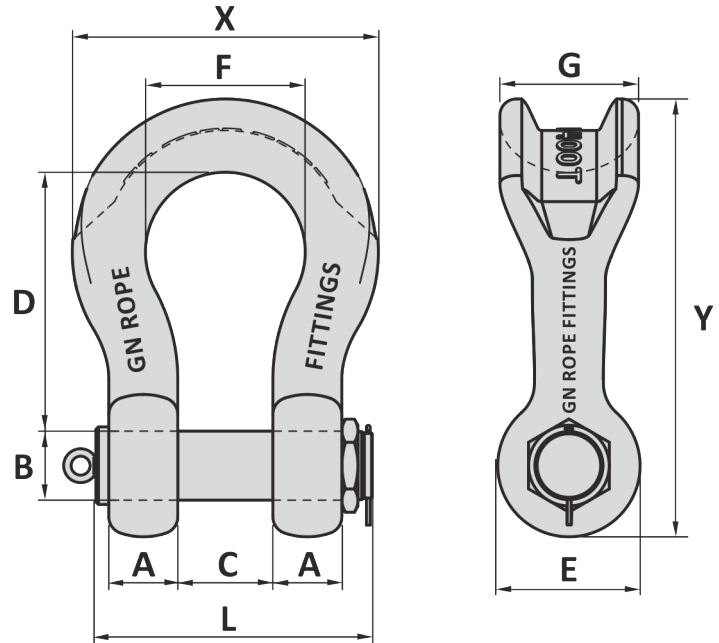
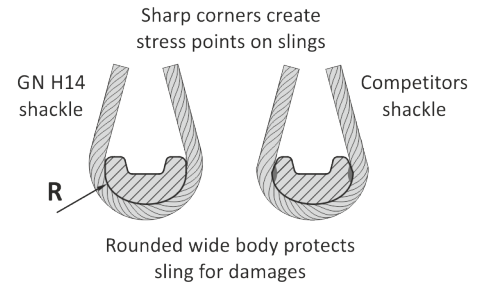

* Shackles from WLL 30 ≤ 125 ton are not supplied with an eyebolt, shackles from WLL 900 ton completed with eyebolts on both sides

Art. No.	WLL ton	A inch	B inch	C inch	D inch	E inch	F inch	G inch	L inch	R inch	X inch	Y inch	Weight lbs
36000025	30	1 3/8	1 1/4	2 1/16	7 3/32	3 1/16	5 1/2	3 3/32	7 15/16	1 25/32	8 1/2	11 1/2	31
36000040	40	1 29/32	2	3 3/16	7 7/8	4 3/32	5 1/2	3 1/16	9 15/16	2 3/32	9 1/8	13 1/32	46
36000055	55	2 1/16	2 3/16	3 3/4	9 27/32	5 1/8	6 5/16	4 7/16	11 13/16	2 5/32	11 11/32	15 3/4	73
36000075	75	2 15/16	2 3/4	4 3/16	11 13/16	5 29/32	7 3/32	4 23/32	13 19/32	2 3/8	13 3/32	19 3/32	117
36000125	125	3 11/32	3 3/32	5 1/2	14 1/16	6 1/2	8 21/32	5 29/32	15 9/16	3 5/32	15 11/32	22 15/16	185
36000150	150	3 3/16	3 3/4	5 29/32	15 3/4	7 7/8	9 27/32	6 11/16	16 17/32	3 9/16	16 7/8	25 1/8	254
36000200	200	4 7/8	4 1/8	6 5/16	18 29/32	8 7/8	10 13/16	8 1/16	18 1/2	4 5/16	19 1/16	29 23/32	403
36000250	250	4 23/32	4 23/32	7 3/32	21 21/32	9 7/16	11 13/16	9 1/16	20 15/32	4 15/16	21 1/4	33 15/32	562
36000300	300	5 1/2	5 9/32	7 11/16	23 5/8	11 1/32	13 25/32	10 7/16	22 27/32	5 1/2	24 23/32	37 9/32	811
36000400	400	6 5/16	6 1/16	9 1/16	24 13/32	13	14 9/16	12 19/32	25 25/32	6 11/16	27 7/8	40 3/4	1259
36000500	500	6 11/16	7 3/32	10 7/16	26 25/32	13 25/32	17 1/16	13 3/8	27 15/16	7 3/32	30 1/16	44 9/32	1585
36000600	600	7 3/32	7 7/8	11 13/32	28 11/32	15 15/16	19 9/32	14 9/16	31 5/16	7 15/32	33 11/32	47 3/4	2116
36000700	700	8 1/4	8 15/32	12 19/32	30 23/32	18 1/16	21 1/4	15 3/4	34 21/32	8 1/4	37 11/16	52 3/8	2976
36000800	800	8 27/32	9 1/16	13 19/32	31 1/2	18 1/16	21 27/32	16 17/32	36 13/32	8 21/32	38 31/32	53 15/32	3086
36000900	900	9 1/4	9 27/32	14 9/16	33 15/32	18 29/32	23 1/2	17 3/16	39 3/4	9 1/4	41 1/4	57 3/32	4079
36001000	1000	9 3/4	10 3/8	15 3/4	33 15/32	20 7/8	24 7/32	18 1/8	41 11/32	9 7/16	42 15/16	58 27/32	4519
36001250	1250	10 13/16	11 13/16	17 29/32	37 13/16	22 7/16	25 3/8	22 1/16	47 3/8	11 7/32	47 7/16	66 3/4	6614
36001500	1550	10 13/16	12 19/32	19 3/32	38 19/32	24	26 25/32	22 27/32	48 13/16	11 13/32	48 13/16	68 11/16	7275
36001750	1750	12 3/16	14 3/16	19 11/16	44 3/32	26	27 9/16	23 5/8	52 5/32	11 13/16	53	77 3/32	10362
36002000	2000	12 19/32	15 5/32	20 15/32	44 7/8	26 25/32	27 3/4	24 13/32	53 3/4	12 3/16	53 7/8	79 3/32	10582
36002500	2500	13	15 3/4	20 15/32	44 7/8	29 1/8	27 15/16	25	54 5/16	12 19/32	54 3/16	81 1/16	11905
36003000	3000	13 3/8	16 17/32	20 7/8	44 7/8	29 19/16	28 11/32	25 19/32	55 1/2	13	55 5/8	81 1/8	12787
36003500	3500	13 25/32	17 1/16	21 1/4	44 7/8	31 3/32	29 17/32	26 3/8	58 1/4	13 3/8	58 1/4	83 3/8	14991
36004000	4000	14 3/16	18 1/8	21 21/32	44 7/8	31 1/8	29 15/16	27 3/32	59 7/16	13 25/32	59 7/16	84 1/4	15873

Tolerance: Inside length ± 7.5%, all other forged parts ± 5%, machined parts ± 1/32 inch

11-01-2021

Material : Alloy steel
 Safety factor : ≤ 2000 ton 5 times
 > 2000 ≤ 3000 ton 4,5 times
 > 3000 ton 4 times
 Finish : Painted
 Temperature range : ≤ 40 ton -20°C up to +200°C
 > 40 ton -40°C up to +200°C, Polar Rated
 Standard certification : Certificate of Conformity
 3.1 material certificate EN 10204

Non-standard sizes or custom products available on request

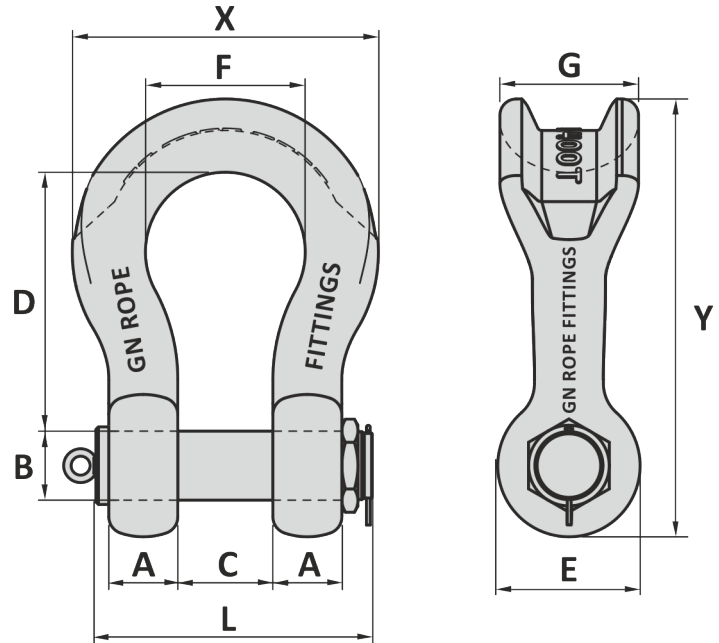
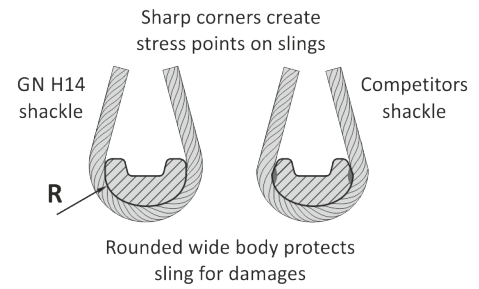

* Shackles from WLL 30 ≤ 125 ton are not supplied with an eyebolt, shackles from WLL 900 ton completed with eyebolts on both sides

Art. No.	WLL ton	A mm	B mm	C mm	D mm	E mm	F mm	G mm	L mm	R mm	X mm	Y mm	Weight kg
36000025	30	35	44	65	180	90	128	80	202	45	204	292	14
36000040	40	45	51	84	200	109	140	97	252	53	232	331	21
36000055	55	65	56	95	250	130	160	110	300	55	288	400	33
36000075	75	75	70	110	300	150	185	120	345	60	334	485	53
36000125	125	85	80	140	370	165	220	150	395	80	390	583	84
36000150	150	90	95	150	400	200	250	170	420	90	429	638	115
36000200	200	105	105	160	480	225	275	205	470	110	484	755	183
36000250	250	120	120	180	550	240	300	230	520	125	540	850	255
36000300	300	140	134	195	600	280	350	265	580	140	628	947	368
36000400	400	160	160	230	620	330	370	320	655	170	689	1035	571
36000500	500	170	180	265	680	350	440	340	710	180	779	1125	719
36000600	600	180	200	290	720	405	490	370	795	190	847	1213	960
36000700	700	210	215	320	780	465	540	400	880	210	957	1330	1350
36000800	800	220	230	345	800	465	555	420	925	220	990	1358	1400
36000900	900	235	250	370	850	480	585	440	1010	235	1060	1450	1850
36001000	1000	235	270	400	850	530	615	460	1050	240	1091	1490	2050
36001250	1250	275	300	455	960	570	645	560	1210	285	1205	1695	3000
36001500	1550	275	320	485	980	610	680	580	1240	290	1240	1745	3300
36001750	1750	310	360	500	1120	660	700	600	1325	300	1346	1960	4700
36002000	2000	320	385	520	1140	680	705	620	1365	310	1368	2012	4800
36002500	2500	330	400	520	1140	740	710	635	1380	320	1383	2065	5400
36003000	3000	340	420	530	1140	760	720	650	1410	330	1413	2080	5800
36003500	3500	350	440	540	1140	790	750	670	1480	340	1480	2130	6800
36004000	4000	360	460	550	1140	810	760	690	1510	350	1510	2140	7200

Tolerance: Inside length ± 7.5%, all other forged parts ± 5%, machined parts ± 1 mm

11-01-2021

GENERAL

Material : Alloy steel
 Finish : Painted
 Temperature range : -4°F up to +392°F
 Standard certification : Certificate of Conformity
 3.1 material certificate EN 10204

SHACKLES

Non-standard sizes or custom products available on request
 Suitable on all our type dee, bow and wide body shackles

THIMBLES

SOCKETS

LINKS

SWIVELS

HOOKS

MOORING

OTHERS

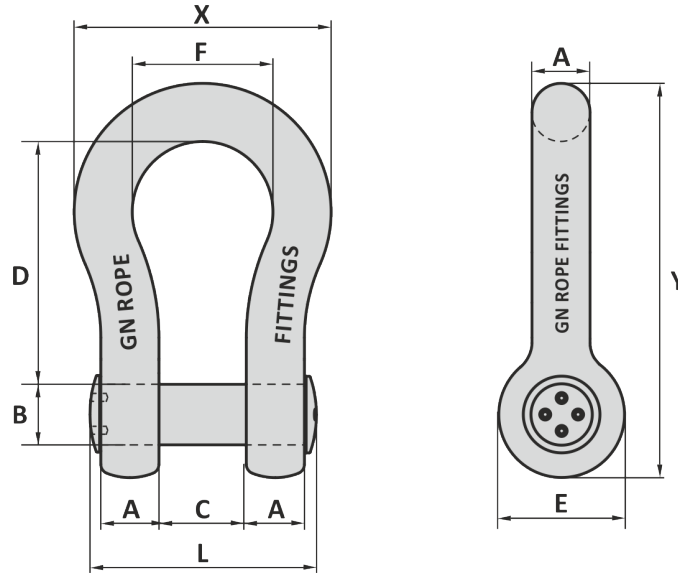

Art. No.	WLL ton	A inch	B inch	C inch	D inch	E inch	F inch	L inch	X inch	Y inch	Weight lbs
H9											
37000256	25	1 25/32	1 31/32	2 29/32	7	4 1/16	4 31/32	7 11/16	8 1/2	11 13/16	37
37000356	35	1 31/32	2 1/4	3 1/4	7 3/4	4 3/8	5 1/16	8 7/16	9 3/8	13 1/32	46
37000426	42.5	2 1/4	2 9/16	3 3/4	8 3/4	5 1/8	6 5/16	9 23/32	10 25/32	14 27/32	64
37000556	55	2 9/16	2 3/4	4 1/8	10 1/4	5 23/32	7 3/32	10 7/8	12 3/16	17 1/16	95
37000856	85	2 15/16	3 1/4	5	12 15/16	6 3/8	7 15/32	12 1/2	13 3/8	20 3/4	139
H10											
37001205	120	3 1/2	3 3/4	5 29/32	14 31/32	7 7/8	9 5/8	14 9/16	16 3/8	24 9/32	243
37001505	150	4	4 1/4	6 11/16	15 3/4	9 1/16	10 13/16	16 3/8	18 7/8	26 13/32	353
37002005	200	4 23/32	4 15/16	7 3/32	19 11/16	10 1/4	11 13/32	18 3/16	20 7/8	32	518
37002505	250	4 15/16	5 1/2	8 1/16	21 1/4	10 1/4	12	20	21 27/32	34 1/16	628
37003005	300	5 1/8	5 29/32	8 1/16	23 3/8	12	12	20 3/8	22 1/4	37 23/32	750
H10 SUPER											
38000406	40	1 25/32	1 31/32	2 29/32	7	4 1/16	4 31/32	7 11/16	8 1/2	11 13/16	33
38000556	55	2 1/4	2 1/4	3 1/4	7 3/4	4 3/8	5 1/16	8 31/32	9 15/16	13 7/16	49
37000858	85	2 3/4	2 3/4	4 1/8	10 1/4	5 5/8	7 3/32	11 5/16	12 19/32	17 3/16	93
37001106	120	3 5/32	3 1/4	5	12 15/16	6 3/8	7 15/32	12 29/32	13 25/32	20 15/16	154
37001406	150	3 9/16	3 3/4	5 5/16	14 31/32	7 7/8	9 7/16	14 1/16	16 17/32	24 1/8	243
37001756	175	4	4 1/4	5 1/2	15 3/4	9 1/16	9 29/32	15 3/16	17 23/32	26 11/32	331
37002006	200	4 23/32	4 3/4	7 3/32	19 11/16	10 1/4	11 13/32	18 3/16	20 7/8	31 15/16	496
37002506	250	4 15/16	5	8 21/32	20 15/32	10 1/4	12 13/16	20 5/32	22 5/8	33 1/32	661
37003006	300	5 5/16	6	8 21/32	19 11/16	12	13	21 3/8	24	34 1/32	776
H14											
36000045	40	1 25/32	2	3 5/16	7 7/8	4 9/32	5 1/2	8 1/16	9 5/8	13 1/32	46
36000058	55	2 9/16	2 3/16	3 3/4	9 27/32	5 1/8	6 5/16	10 1/16	11 11/32	15 3/4	73
36000078	75	2 15/16	2 3/4	4 5/16	11 13/16	5 29/32	7 3/32	11 7/8	13 5/32	19 3/32	117
36000128	125	3 11/32	3 5/32	5 1/2	14 9/16	6 1/2	8 21/32	13 7/8	15 11/32	22 15/16	185
36000155	150	3 9/16	3 3/4	5 29/32	15 3/4	7 7/8	9 27/32	14 21/32	16 7/8	25 1/8	254
36000205	200	4 1/8	4 1/8	6 5/16	18 29/32	8 3/8	10 13/16	16 7/32	19 1/16	29 23/32	403
36000255	250	4 23/32	4 23/32	7 3/32	21 21/32	9 7/16	11 13/16	18 3/16	21 1/4	33 15/32	562
36000305	300	5 1/2	5 5/32	7 11/16	23 3/8	11 1/32	13 25/32	20 25/32	24 23/32	37 5/32	811
36000405	400	6 5/16	6 5/16	9 1/16	24 15/32	13	14 9/16	23 3/4	27 1/8	40 3/4	1259

Tolerance: Inside length ± 7.5%, all other forged parts ± 5%, machined parts ± 1 mm

12-12-2023

Material : Alloy steel
 Finish : Painted
 Temperature range : -20°C up to +200°C
 Standard certification : Certificate of Conformity
 3.1 material certificate EN 10204

Non-standard sizes or custom products available on request
 Suitable on all our type dee, bow and wide body shackles

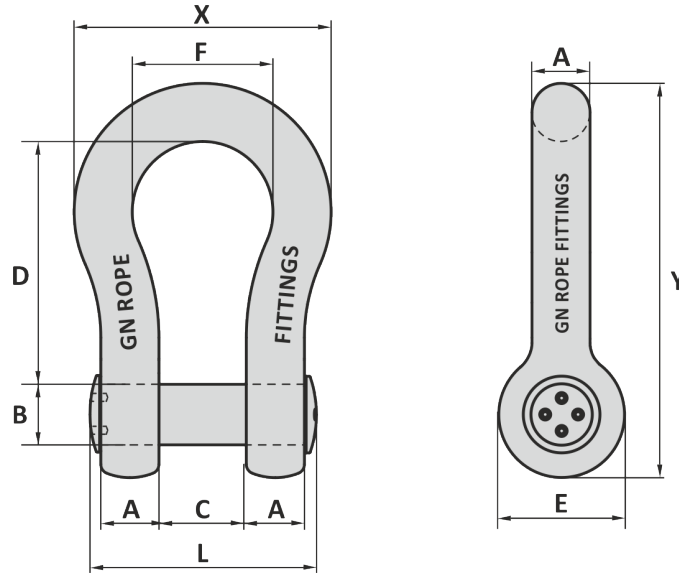

Art. No.	WLL ton	A mm	B mm	C mm	D mm	E mm	F mm	L mm	X mm	Y mm	Weight kg
H9											
37000256	25	45	50	74	178	103	126	195	216	300	17
37000356	35	50	57	83	197	111	138	214	238	331	21
37000426	42.5	57	65	95	222	130	160	250	274	377	29
37000556	55	65	70	105	260	145	180	276	310	433	43
37000856	85	75	83	127	329	162	190	318	340	527	63
H10											
37001205	120	89	95	150	380	200	238	370	416	617	110
37001505	150	102	108	170	400	230	275	416	479	671	160
37002005	200	120	125	180	500	260	290	462	530	813	235
37002505	250	125	140	205	540	260	305	508	555	865	285
37003005	300	130	150	205	600	305	305	518	565	958	340
H10 SUPER											
38000406	40	45	50	74	178	103	126	195	216	300	15
38000556	55	57	57	83	197	117	138	228	252	341	22
37000858	85	70	70	105	260	143	180	287	320	437	42
37001106	120	80	83	127	329	162	190	328	350	532	70
37001406	150	90	95	135	380	200	240	357	420	613	110
37001756	175	102	108	140	400	230	250	386	450	669	150
37002006	200	120	121	180	500	260	290	462	530	811	225
37002506	250	125	127	220	520	260	325	512	575	839	300
37003006	300	135	152	220	500	305	330	543	610	869	352
H14											
36000045	40	45	51	84	200	109	140	205	232	331	21
36000058	55	65	56	95	250	130	160	256	288	400	33
36000078	75	75	70	110	300	150	185	302	334	485	53
36000128	125	85	80	140	370	165	220	352	390	583	84
36000155	150	90	95	150	400	200	250	372	429	638	115
36000205	200	105	105	160	480	225	275	412	484	755	183
36000255	250	120	120	180	550	240	300	462	540	850	255
36000305	300	140	134	195	600	280	350	528	628	947	368
36000405	400	160	160	230	620	330	370	603	689	1035	571

Tolerance: Inside length ± 7.5%, all other forged parts ± 5%, machined parts ± 1 mm

12-12-2023

HOOKS



HOOKS

Application information

Hooks are used in towing, mooring and lifting systems as a connection between slings, rope, wire rope and chain. ROV type hooks are modified for easy ROV handling during hook-up or release.

Eye hooks HK2 are generally used for lifting systems. The HK2 modified ROV type can be used subsea. Slip or pelican HK3 and HK4 hooks are generally used for towing systems as a quick release application. ROV shank hooks HK5 are specially designed for subsea use by ROV's. Due the shape and size of the shank the ROV has a perfect on the hook. Anchor line hooks HK6 are designed for release of anchor lines. Soft sling hooks HK14 are specially designed with an enlarged radius to protect the soft sling for bending damage, which improves the durability of the softsling. KS-hooks HK12 are used in mooring lines

Instructions for use

The hook must always support the load. The load must never be supported by the latch. Never use a hook whose throat opening has been increased or whose tip has been bent more than 10° out of the plane from the hook body or is in any other way distorted or bent. The latch will not work properly on a hook with a bent or worn tip. Never repair, alter rework or reshape a hook by welding, heating, burning or bending. When placing 2 sling legs in a hook, make sure that the angle between the legs does not exceed 90°.

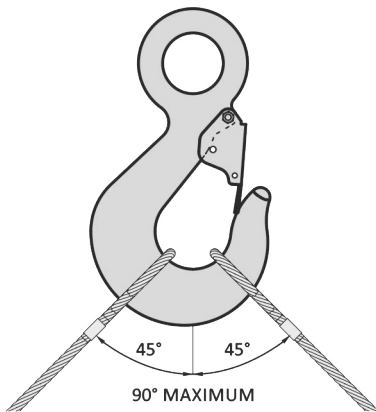

Right

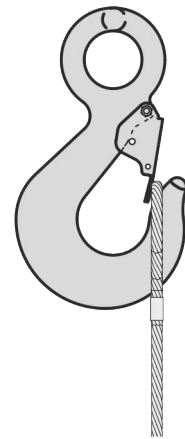

Wrong

Never side load, back load or tip load a hook.

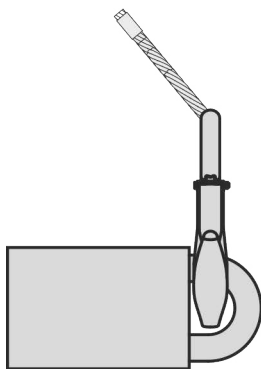

Wrong

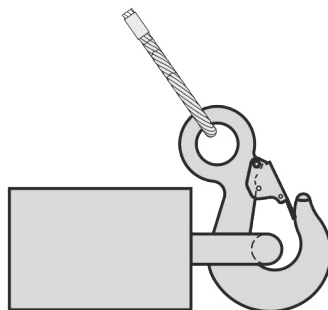

Wrong

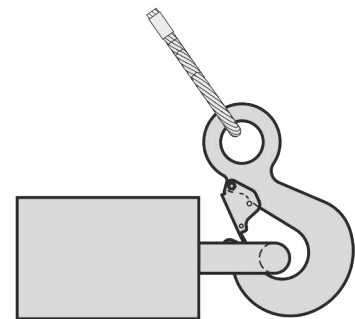

Wrong

Material : Alloy steel
 Safety factor : 4 times
 Finish : Painted
 Temperature range : -40°C up to +200°C, Polar Rated
 Standard certification : Certificate of Conformity
 3.1 material certificate EN 10204

Spare latches available on request

Standard hook with safety latch

ROV-hook

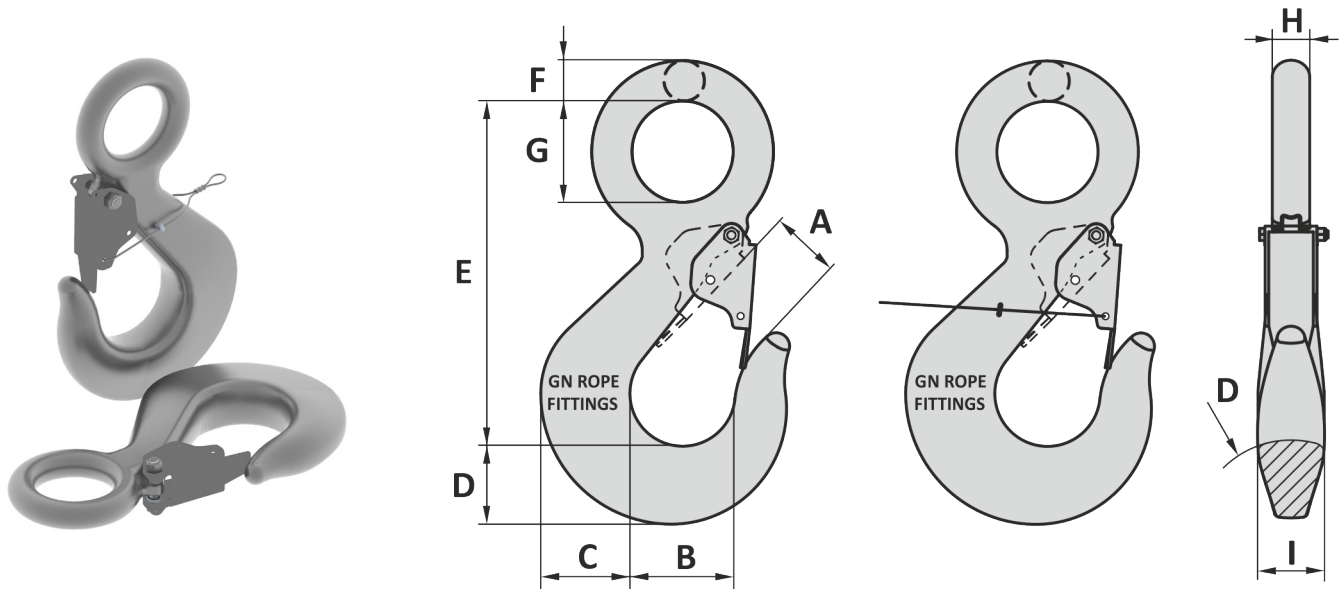

Art. No. standard	Art. No. ROV	Art. No. latch	WLL ton	A mm	B mm	C mm	D mm	E mm	F mm	G mm	H mm	I mm	Weight kg
51000008	51000009	53000003	8	42	62	54	49	187	23	51	23	37	3.6
51000012	51000013	53000010	11.5	48	75	68	60	230	29	64	29	43	6.7
51000016	51000017	53000022	16	56	84	76	67	255	33	70	33	52	9.7
51000020	51000021	53000018	22	74	110	93	80	320	41	89	41	64	17
51000028	51000029	53000023	28	75	111	99	85	354	38	95	38	63	19
51000031	51000032	53000031	31	86	124	109	95	389	43	100	43	70	26
51000040	51000041	53000030	40	98	139	121	106	457	48	130	48	80	37
51000050	51000051	53000035	50	113	157	139	120	495	54	130	54	89	52
51000063	51000064	53000036	63	124	175	155	134	565	60	150	60	99	73
51000080	51000081	53000037	80	137	197	172	149	690	67	170	67	110	106
51000100	51000101	53000137	100	155	225	200	177	725	79	175	79	125	158

Tolerance: Forged parts ± 5%, machined parts ± 1 mm

Art. No. standard	Art. No. ROV	Art. No. latch	WLL ton	A inch	B inch	C inch	D inch	E inch	F inch	G inch	H inch	I inch	Weight lbs
51000008	51000009	53000003	8	1 21/32	2 1/16	2 1/8	1 15/16	7 3/8	29/32	2	29/32	1 7/16	8.6
51000012	51000013	53000010	11.5	1 27/32	2 15/16	2 11/16	2 3/8	9 1/16	1 1/8	2 1/2	1 1/8	1 11/16	16
51000016	51000017	53000022	16	2 5/32	3 3/16	3	2 5/8	10 1/32	1 5/16	2 3/4	1 5/16	2 1/16	22
51000020	51000021	53000018	22	2 29/32	4 5/16	3 19/32	3 5/32	12 19/32	1 5/8	3 1/2	1 5/8	2 1/2	42
51000028	51000029	53000023	28	2 29/32	4 13/32	3 25/32	3 1/4	13 15/16	1 13/32	3 3/4	1 13/32	2 15/32	37
51000031	51000032	53000031	31	3 11/32	4 15/16	4 3/16	3 5/8	15 5/16	1 9/16	3 15/16	1 9/16	2 3/4	51
51000040	51000041	53000030	40	3 25/32	5 1/2	4 21/32	4 1/16	18	1 25/32	5 1/8	1 25/32	3 5/32	75
51000050	51000051	53000035	50	4 3/8	6 7/32	5 5/16	4 9/16	19 1/2	2	5 1/8	2	3 1/2	108
51000063	51000064	53000036	63	4 27/32	6 15/16	5 15/16	5 1/8	22 1/4	2 3/16	5 29/32	2 3/16	3 29/32	139
51000080	51000081	53000037	80	5 11/32	7 13/16	6 5/8	5 23/32	27 5/32	2 15/32	6 11/16	2 15/32	4 5/16	218
51000100	51000101	53000137	100	6 1/32	8 7/8	7 11/16	6 25/32	28 5/16	2 29/32	6 7/8	2 29/32	4 15/16	353

Tolerance: Forged parts ± 5%, machined parts ± 1/32 inch

17-06-2022

GENERAL SHACKLES THIMBLES SOCKETS LINKS SWIVELS HOOKS MOORING OTHERS

GENERAL

Material : Alloy steel
 Safety factor : 4 times
 Standards : DIN 7540
 Finish : Painted
 Temperature range : -40°F up to +392°F, Polar Rated
 Standard certification : Certificate of Conformity
 3.1 material certificate EN 10204

SHACKLES

Spare latches available on request

THIMBLES

SOCKETS

LINKS

SWIVELS

HOOKS

MOORING

OTHERS

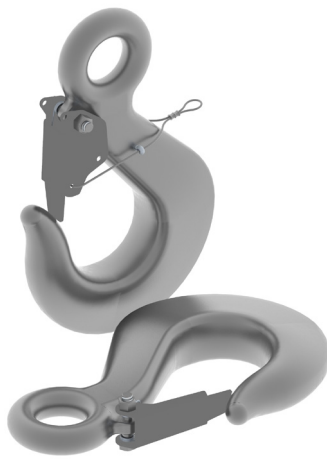

Standard hook with safety latch

ROV-hook

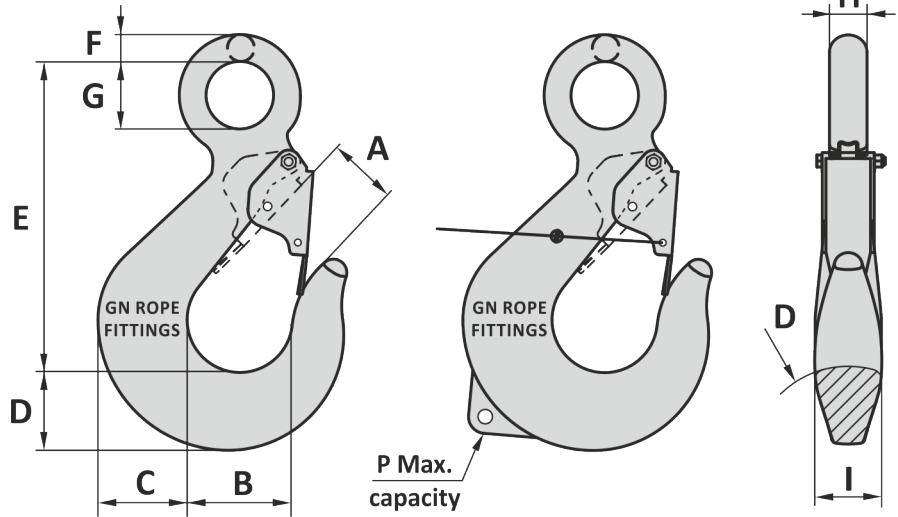

* Standard hooks from WLL 250 ton will supplied with a handling padeye with maximum capacity P, hooks WLL 100 ≤ 200 ton on request

Art. No. standard	Art. No. ROV	Art. No. latch	WLL ton	A inch	B inch	C inch	D inch	E inch	F inch	G inch	H inch	I inch	P ton	Weight lbs
45001009	45001010	45001007	8	1 1/16	2 7/16	2 1/8	1 13/16	6 27/32	2 5/32	1 1/4	2 5/32	1 3/8		6.4
45001013	45001014	45001011	12.5	2 1/16	3 1/8	2 23/32	2 3/8	8 5/8	1 1/32	1 1/16	1 1/32	1 25/32		13
45001017	45001018	45001019	16	2 5/16	3 15/32	2 15/16	2 1/2	9 11/16	1 3/32	1 13/16	1 3/32	1 31/32		18
45001021	45001022	45001023	20	2 1/2	3 3/8	3 3/16	3	10 29/32	1 11/32	2	1 11/32	2 3/16		26
45001029	45001030	45001027	28	2 29/32	4 3/8	3 29/32	3 11/32	12 5/16	1 1/2	2 3/16	1 1/2	2 15/32		37
45001032	45001033	45001034	31	3 5/32	4 15/16	4 5/32	3 11/16	13 3/4	1 11/16	2 3/16	1 11/16	2 3/4		55
45001041	45001042	45001034	40	3 29/32	5 15/32	4 3/4	4 3/16	15 9/32	1 27/32	2 2/32	1 27/32	3 5/32		75
45001051	45001051	45001053	50	4 3/16	6 3/16	5 15/32	4 23/32	17 13/32	2 1/8	3 3/16	2 1/8	3 1/2		108
45001064	45001065	45001066	63	4 3/4	6 7/8	6 3/32	5 9/32	19 7/16	2 3/8	3 3/16	2 3/8	3 29/32		148
45001081	45001082	45001079	80	5 3/16	7 3/4	6 25/32	5 7/8	24	2 5/8	4	2 5/8	4 1/16		218
45001101	45001102	45001103	100	6 1/16	8 7/8	7 7/8	6 31/32	25 19/32	3 3/8	4 3/16	3 3/8	4 15/16		326
51000150	51000151	53000039	150	7 1/8	9 27/32	9 1/16	8	30 1/8	3 19/32	5 1/8	3 19/32	6 5/16		542
51000200	51000201	53000041	200	8 3/16	10 13/16	10 7/16	9 7/16	33 15/32	4 7/32	5 29/32	4 7/32	7 3/32		820
51000250	51000251	53000044	250	9 3/16	12 3/16	11 21/32	10 13/16	36 17/32	4 31/32	6 11/16	4 31/32	7 7/8	9.5	1171
51000300	51000301	53000042	300	10 3/8	13 25/32	13 1/4	12 15/32	41 13/32	5 25/32	7 15/32	5 25/32	8 21/32	12	1717
51000400	51000401	53010400	400	11 15/16	15 3/4	15 5/32	13 3/8	47 1/16	6 27/32	8 1/4	6 27/32	9 1/16	17	2522
51000500	51000501	53010400	500	14 1/16	17 23/32	16 1/8	15 11/32	53 3/16	7 7/8	8 15/32	7 7/8	12 19/32	17	4057

Tolerance: Forged parts ± 5%, machined parts ± 1/32 inch

11-11-2021

Material : Alloy steel
 Safety factor : 4 times
 Standards : DIN 7540
 Finish : Painted
 Temperature range : -40°C up to +200°C, Polar Rated
 Standard certification : Certificate of Conformity
 3.1 material certificate EN 10204

Spare latches available on request

GENERAL

SHACKLES

THIMBLES

SOCKETS

LINKS

SWIVELS

HOOKS

MOORING

OTHERS

Standard hook with safety latch

ROV-hook

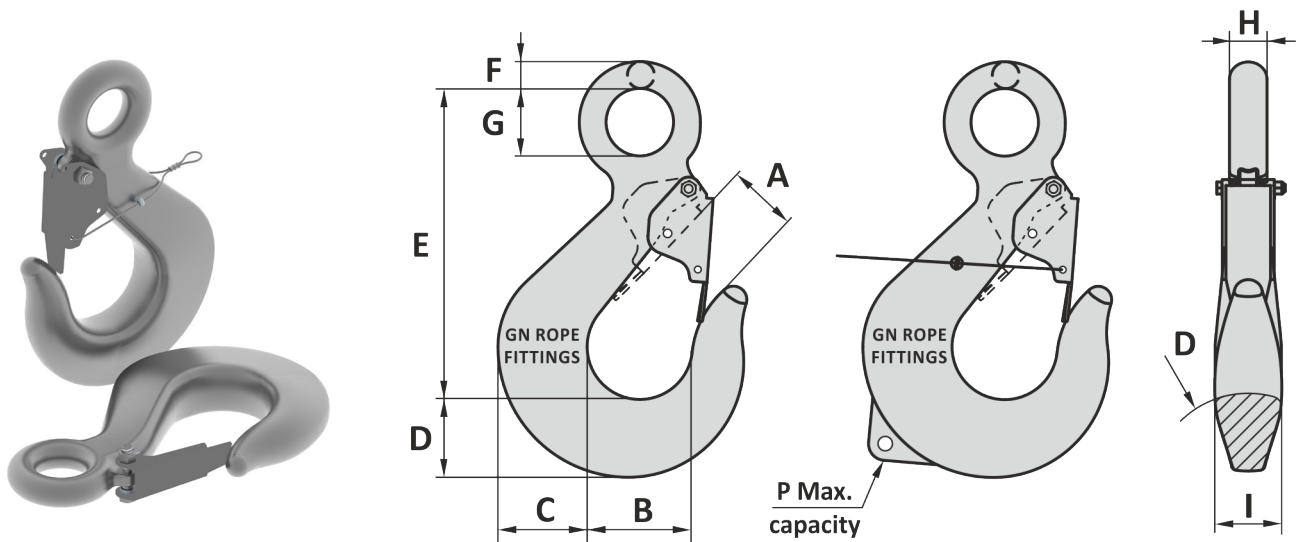

* Standard hooks from WLL 250 ton will supplied with a handling padeye with maximum capacity P, hooks WLL 100 ≤ 200 ton on request

Art. No. standard	Art. No. ROV	Art. No. latch	WLL ton	A mm	B mm	C mm	D mm	E mm	F mm	G mm	H mm	I mm	P ton	Weight kg
45001009	45001010	45001007	8	40	62	54	46	174	20	32	20	35		2.9
45001013	45001014	45001011	12.5	52	79	69	60	219	26	40	26	45		6.1
45001017	45001018	45001019	16	59	88	75	64	246	28	46	28	50		8.1
45001021	45001022	45001023	20	64	98	87	76	277	34	51	34	56		12
45001029	45001030	45001027	28	74	111	99	85	313	38	59	38	63		17
45001032	45001033	45001034	31	82	125	109	94	349	43	65	43	70		25
45001041	45001042	45001034	40	99	139	121	106	388	47	72	47	80		34
45001051	45001051	45001053	50	110	157	139	120	442	54	84	54	89		49
45001064	45001065	45001066	63	121	175	155	134	494	60	90	60	99		67
45001081	45001082	45001079	80	132	197	172	149	610	67	102	67	110		99
45001101	45001102	45001103	100	154	225	200	177	650	79	116	79	125		148
51000150	51000151	53000039	150	181	250	230	203	765	91	130	91	160		246
51000200	51000201	53000041	200	208	275	265	240	850	107	150	107	180		372
51000250	51000251	53000044	250	233	310	296	275	928	126	170	126	200	9.5	531
51000300	51000301	53000042	300	264	350	337	317	1052	147	190	147	220	12	779
51000400	51000401	53010400	400	303	400	388	352	1195	174	210	174	240	17	1144
51000500	51000501	53010400	500	370	450	410	390	1360	200	215	200	320	17	1840

Tolerance: Forged parts ± 5%, machined parts ± 1 mm

11-11-2021

GENERAL
SHACKLES
THIMBLES
SOCKETS
LINKS
SWIVELS
HOOKS
MOORING
OTHERS

Material : Alloy steel
 Safety factor : 4 times
 Finish : Painted
 Temperature range : -40°F up to +392°F, Polar Rated
 Standard certification : Certificate of Conformity
 3.1 material certificate EN 10204

Spare latches available on request

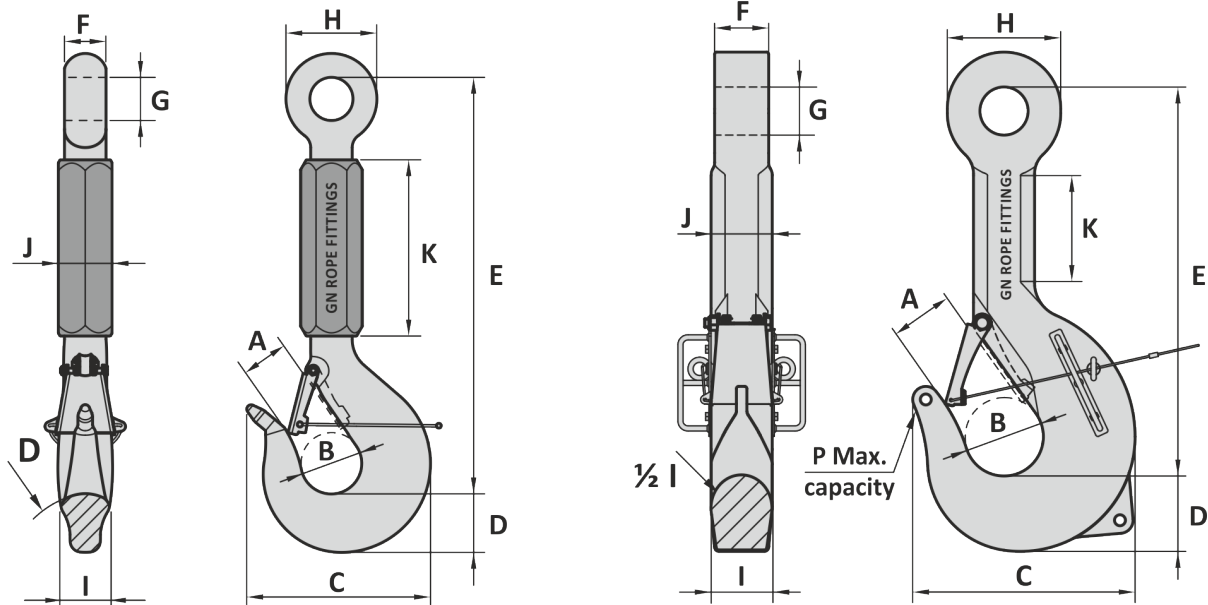
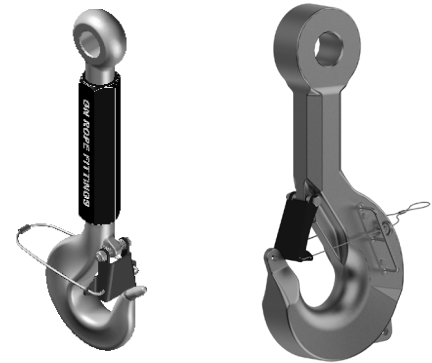

Type for hook WLL 40 ton ≤ WLL 80 ton

Type for hook WLL 100 ton ≤ WLL 400 ton

Art. No.	WLL ton	A inch	B inch	C inch	D inch	E inch	F inch	G inch	H inch	I inch	J inch	K inch	P ton	Weight lbs
53000040	42.5	2 23/32	3 15/16	12 7/16	3 3/4	30 23/32	2 3/4	2 3/4	5 29/32	2 15/16	3 11/32	13		104
53000050	55	3 3/16	4 13/32	13 1/2	4 3/16	31 13/16	3 5/32	3 1/16	6 3/8	3 11/32	3 15/16	13 25/32		137
53000063	63	3 19/32	4 15/16	14 13/16	4 21/32	37 13/32	3 11/32	3 3/8	7 3/32	3 3/4	4 5/16	14 3/16		194
53000080	85	4 3/32	5 1/2	16 7/16	5 3/16	35 5/32	3 15/16	3 3/8	7 7/8	4 3/16	4 23/32	11 13/32		245
53000100	100	5 1/2	6 7/8	18 19/32	5 29/32	32 23/32	4 5/16	3 15/16	8 21/32	4 23/32	4 23/32	9 7/16	4.75	392
53000125	125	5 23/32	7 3/32	20 1/32	6 11/16	35 1/32	4 7/8	4 5/16	10 1/4	5 1/2	5 1/2	9 7/16	4.75	549
53000160	160	6 3/16	7 15/32	24 3/16	7 15/32	37 1/2	5 7/16	5 5/16	11 13/16	6 5/16	5 29/32	9 27/32	6.5	798
53000200	200	6 15/16	8 13/16	27 3/32	9 7/16	39 3/32	5 13/16	5 5/16	13 25/32	6 7/8	5 29/32	9 27/32	8.5	1093
53000250	250	7 5/8	9 27/32	30 23/32	10 1/16	41 27/32	6 7/8	5 23/32	14 9/16	7 7/8	6 5/16	9 27/32	8.5	1479
53000300	300	8 1/4	11 1/32	29 23/32	10 1/32	45 3/8	7 15/32	6 3/32	14 3/16	8 21/32	6 11/16	11 13/16	9.5	1742
53000400	400	9 5/32	12 13/32	33 21/32	12	49 9/16	8 3/4	7 5/32	16 17/32	9 7/16	7 15/32	11 13/16	9.5	2346

Tolerance: Forged parts ± 5%, machined parts ± 1/32 inch

19-09-2023

Material : Alloy steel
 Safety factor : 4 times
 Finish : Painted
 Temperature range : -40°C up to +200°C, Polar Rated
 Standard certification : Certificate of Conformity
 3.1 material certificate EN 10204

Spare latches available on request

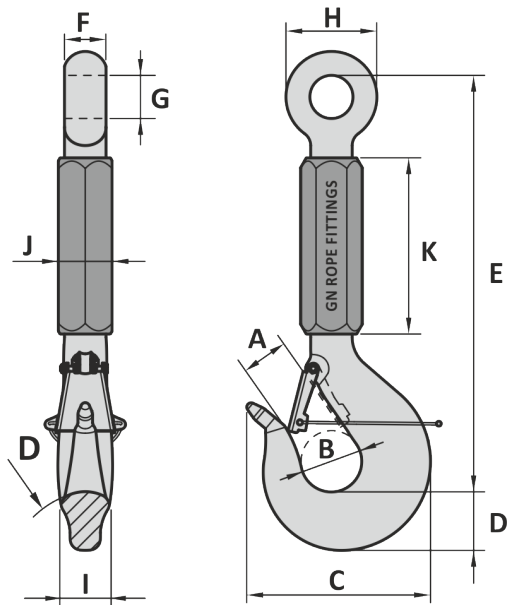
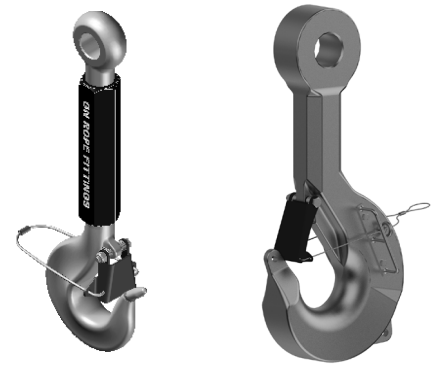

Type for hook WLL 40 ton ≤ WLL 80 ton

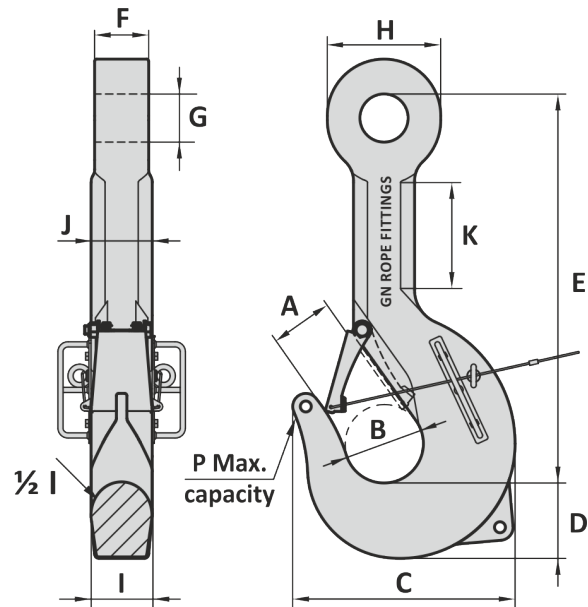

Type for hook WLL 100 ton ≤ WLL 400 ton

Art. No.	WLL ton	A mm	B mm	C mm	D mm	E mm	F mm	G mm	H mm	I mm	J mm	K mm	P ton	Weight kg
53000040	42.5	69	100	316	95	780	70	70	150	75	85	330		47
53000050	55	81	112	343	106	808	80	78	162	85	100	350		62
53000063	63	91	125	376	118	950	85	86	180	95	110	360		92
53000080	85	104	140	418	132	893	100	86	200	106	120	290		111
53000100	100	140	175	472	150	831	110	100	228	120	120	240	4.75	178
53000125	125	145	180	509	170	890	124	110	260	140	140	240	4.75	249
53000160	160	157	190	614	190	953	138	135	300	160	150	250	6.5	362
53000200	200	176	224	688	230	998	148	135	350	175	150	250	8.5	496
53000250	250	194	250	780	256	1063	175	145	370	200	160	250	8.5	671
53000300	300	210	280	755	255	1153	190	155	360	220	170	300	9.5	790
53000400	400	234	315	855	305	1253	210	185	420	240	190	300	9.5	1064

Tolerance: Forged parts ± 5%, machined parts ± 1 mm

25-09-2023

Material : Alloy steel
 Safety factor : 4 times
 Finish : Painted
 Temperature range : -40°C up to +200°C, Polar Rated
 Standard certification : Certificate of Conformity
 3.1 material certificate EN 10204

Spare latches available on request

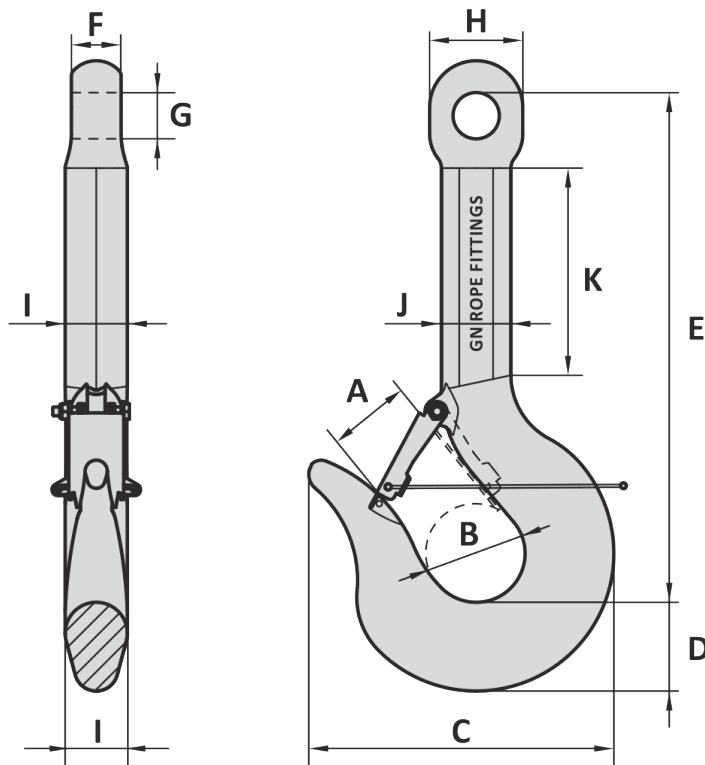
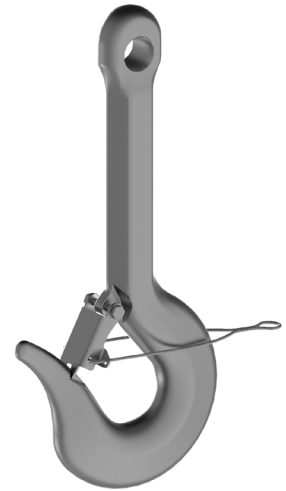

Art. No.	WLL ton	A mm	B mm	C mm	D mm	E mm	F mm	G mm	H mm	I mm	J mm	K mm	Weight kg
53100006	6.5	40	55	182	50	400	30	28	60	45	50	225	8
53100008	8.5	54	68	208	55	450	30	31	75	50	56	228	11
53100012	12	63	80	254	70	480	41	40	78	55	61	227	16
53100017	17	71	90	297	85	514	48	44	88	60	67	226	22
53100025	25	92	110	344	100	574	56	52	105	70	78	233	34
53100035	35	108	130	395	120	628	58	60	124	85	96	230	56

Tolerance: Forged parts ± 5%, machined parts ± 1 mm

Art. No.	WLL ton	A inch	B inch	C inch	D inch	E inch	F inch	G inch	H inch	I inch	J inch	K inch	Weight lbs
53100006	6.5	1 9/16	2 1/2	7 3/2	1 31/32	16 3/4	1 3/16	1 1/32	2 3/8	1 25/32	1 31/32	8 7/8	18
53100008	8.5	2 1/8	2 11/16	8 3/16	2 5/32	18 29/32	1 3/16	1 1/32	2 15/16	1 31/32	2 3/16	8 31/32	24
53100012	12	2 15/32	3 5/32	10	2 3/4	20 1/16	1 5/8	1 1/16	3 1/16	2 5/32	2 13/32	8 15/16	35
53100017	17	2 13/16	3 9/16	11 11/16	3 11/32	21 21/32	1 7/8	1 1/4	3 15/32	2 3/8	2 5/8	8 29/32	49
53100025	25	3 3/8	4 1/16	13 3/16	3 15/16	24	2 3/16	2 1/16	4 1/8	2 3/4	3 1/16	9 3/16	75
53100035	35	4 1/4	5 1/8	15 1/16	4 23/32	26 3/8	2 5/32	2 3/8	4 3/8	3 11/32	3 25/32	9 1/16	123

Tolerance: Forged parts ± 5%, machined parts ± 1/32 inch

05-07-2022

Material : Alloy steel
 Safety factor : 4 times
 Finish : Painted
 Temperature range : -40°C up to +200°C, Polar Rated
 Standard certification : Certificate of Conformity
 3.1 material certificate EN 10204

Spare latches available on request

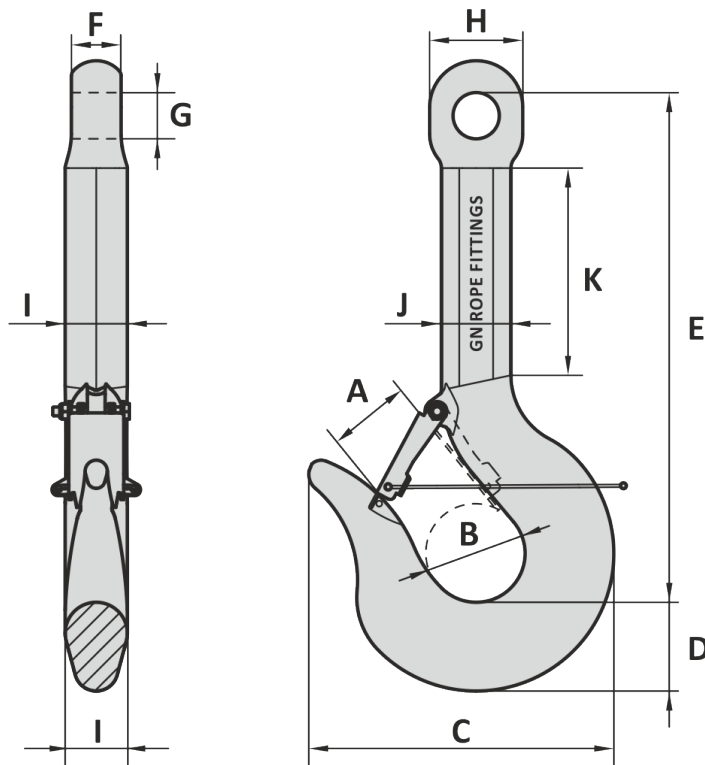
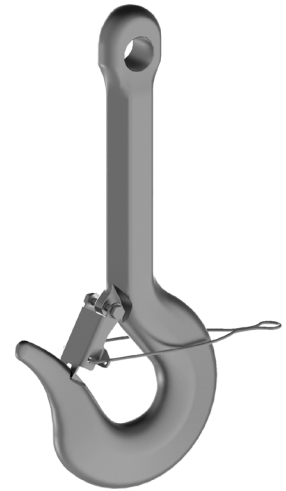

Art. No.	WLL ton	A mm	B mm	C mm	D mm	E mm	F mm	G mm	H mm	I mm	J mm	K mm	Weight kg
53100006	6.5	40	55	182	50	400	30	28	60	45	50	225	8
53100008	8.5	54	68	208	55	450	30	31	75	50	56	228	11
53100012	12	63	80	254	70	480	41	40	78	55	61	227	16
53100017	17	71	90	297	85	514	48	44	88	60	67	226	22
53100025	25	92	110	344	100	574	56	52	105	70	78	233	34
53100035	35	108	130	395	120	628	58	60	124	85	96	230	56

Tolerance: Forged parts ± 5%, machined parts ± 1 mm

Art. No.	WLL ton	A inch	B inch	C inch	D inch	E inch	F inch	G inch	H inch	I inch	J inch	K inch	Weight lbs
53100006	6.5	1 9/16	2 1/2	7 3/2	1 31/32	16 3/4	1 3/16	1 1/32	2 3/8	1 25/32	1 31/32	8 7/8	18
53100008	8.5	2 1/8	2 11/16	8 3/16	2 5/32	18 29/32	1 3/16	1 1/32	2 15/16	1 31/32	2 3/16	8 31/32	24
53100012	12	2 15/32	3 5/32	10	2 3/4	20 1/16	1 5/8	1 1/16	3 1/16	2 5/32	2 13/32	8 15/16	35
53100017	17	2 13/16	3 9/16	11 11/16	3 11/32	21 21/32	1 7/8	1 1/4	3 15/32	2 3/8	2 5/8	8 29/32	49
53100025	25	3 3/8	4 1/16	13 3/16	3 15/16	24	2 3/16	2 1/16	4 1/8	2 3/4	3 1/16	9 3/16	75
53100035	35	4 1/4	5 1/8	15 1/16	4 23/32	26 3/8	2 5/32	2 3/8	4 3/8	3 11/32	3 25/32	9 1/16	123

Tolerance: Forged parts ± 5%, machined parts ± 1/32 inch

05-07-2022

GENERAL
SHACKLES
THIMBLES
SOCKETS
LINKS
SWIVELS
HOOKS
MOORING
OTHERS

Material : Cast steel
 Safety factor : 4 times
 Finish : Galvanized
 Temperature range : -20°C up to +200°C
 Standard certification : Certificate of Conformity

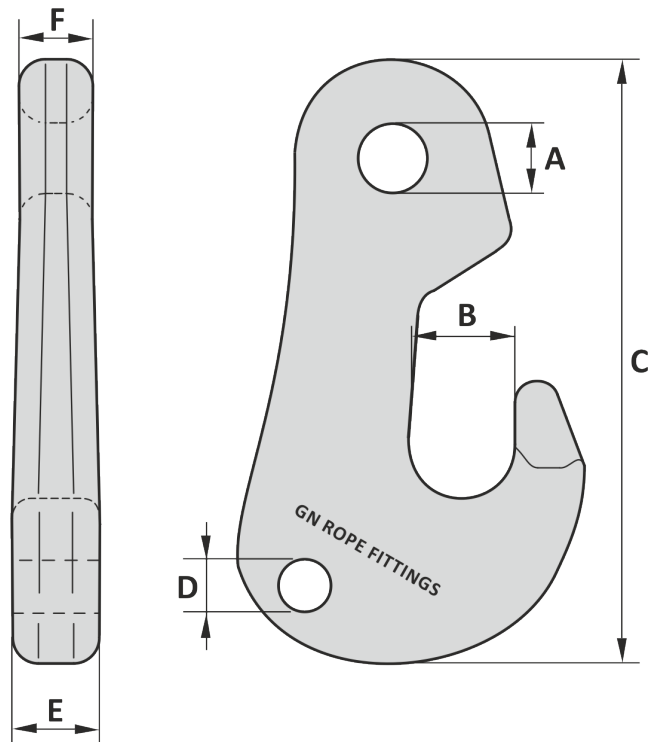
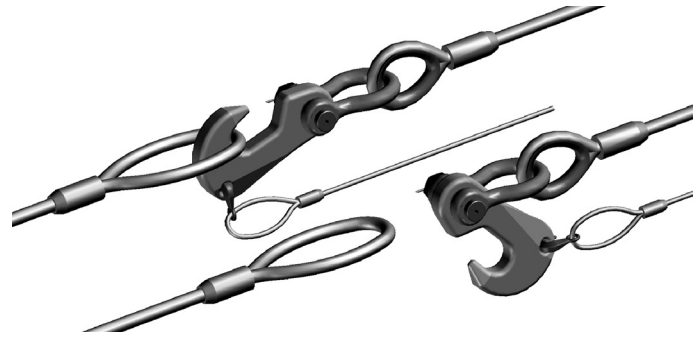

Art. No.	WLL ton	A mm	B mm	C mm	D mm	E mm	F mm	Weight kg
74000015	15	38	58	343	32	45	35	11
74000020	20	40	74	343	32	60	41	14
74000025	25	52	86	440	38	65	51	26
74000050	50	80	112	618	45	90	76	67
74000080	80	90	130	709	62	110	92	116

Tolerance: ± 5%

Art. No.	WLL ton	A inch	B inch	C inch	D inch	E inch	F inch	Weight lbs
74000015	15	1 ½	2 ½	13 ½	1 ¼	1 25/32	1 3/8	24
74000020	20	1 5/16	2 29/32	13 ½	1 ¼	2 3/8	1 5/8	31
74000025	25	2 1/16	3 3/8	17 5/16	1 ½	2 5/16	2	57
74000050	50	3 1/2	4 13/32	24 5/16	1 25/32	3 5/16	3	148
74000080	80	3 5/16	5 1/8	27 29/32	2 7/16	4 5/16	3 3/8	256

Tolerance: ± 5%

02-12-2019

THIMBLES



GENERAL
SHACKLES
THIMBLES
SOCKETS
LINKS
SWIVELS
HOOKS
MOORING
OTHERS

Material : Mild steel
 Finish : Galvanized
 Temperature range : -4°F up to +392°F
 Standard certification : Certificate of Conformity

Suitable for wire rope
 Non-standard sizes or custom products available on request

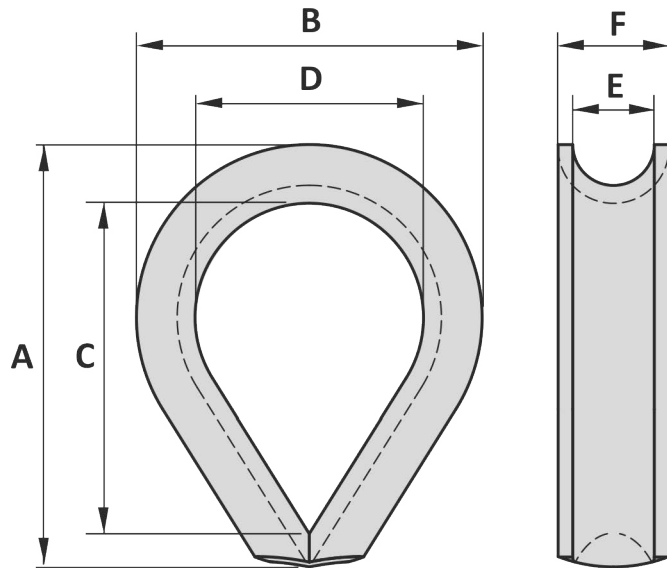

Art. No.	A inch	B inch	C inch	D inch	E inch	F inch	Packing	Weight lbs/100
11020000	2	1 2/32	1 3/8	7/8	1 1/32	9/16	600	18
11025000	2.5	1 3/32	1 25/32	1 3/16	7/16	5/8	400	22
11030000	3	1 3/32	2 5/32	1 3/8	1/2	23/32	300	44
11035000	3.5	2 7/8	2 9/16	1 25/32	19/32	25/32	150	57
11040000	4	2 15/16	2 15/16	1 31/32	1 1/16	7/8	150	79
11045000	4.5	3 11/32	3 5/32	2 3/32	3/4	1	75	110
11050000	5	3 15/16	3 9/16	2 3/8	13/16	1 1/8	75	132
11055000	5.5	4 5/16	3 3/4	2 9/16	29/32	1 3/16	40	154
11060000	6	4 17/32	4 23/32	2 3/4	1	1 11/32	40	220
11070000	7	5 5/16	5 1/2	3 5/32	1 3/16	1 1/2	25	353
11080000	8	6 5/32	6 5/16	3 15/16	1 5/16	1 3/4	20	397
11090000	9	6 7/8	7 7/32	4 17/32	1 1/2	1 15/16		772
11100000	10	7 15/32	7 11/16	4 23/32	1 5/8	2 1/16		970
11110000	11	8 1/4	8 15/32	5 1/8	1 13/16	2 3/8		1146
11120000	12	9 21/32	9 27/32	5 23/32	2 1/16	2 9/16		1609
11140000	14	10 1/4	11 13/32	6 3/32	2 3/8	2 27/32		2425
11170000	17	12 3/16	14 9/16	7 15/32	2 3/4	3 5/16		3527
11190000	19	13 25/32	16 7/32	9 1/16	3 3/16	4 1/16		6063
11220000	22	15 9/16	18 29/32	10 1/32	3 5/8	5 1/8		8047
11240000	24	16 15/16	21 1/4	11 1/32	4 1/8	5 23/32		9700
11260000	26	17 23/32	22 27/32	11 7/32	4 23/32	6 3/32		10362

Tolerance: Forged parts ± 5%

19-05-2015

Material : Mild steel
 Finish : Galvanized
 Temperature range : -20°C up to +200°C
 Standard certification : Certificate of Conformity

Suitable for wire rope
 Non-standard sizes or custom products available on request

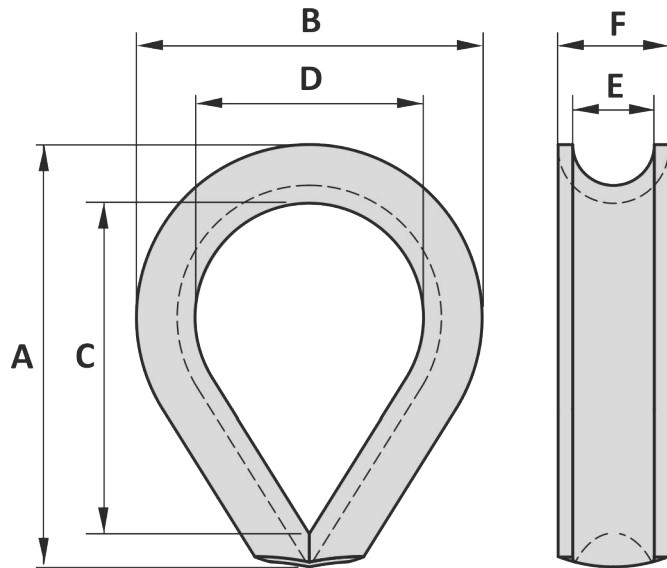

Art. No.	A inch	B mm	C mm	D mm	E mm	F mm	Packing	Weight kg/100
11020000	2	42	35	22	9	14	600	8.2
11025000	2.5	50	45	30	11	16	400	10
11030000	3	50	55	35	13	18	300	20
11035000	3.5	73	65	45	15	20	150	26
11040000	4	75	75	50	17	22	150	36
11045000	4.5	85	80	53	19	25	75	50
11050000	5	100	90	60	21	29	75	60
11055000	5.5	110	95	65	23	33	40	70
11060000	6	115	120	70	25	34	40	100
11070000	7	135	140	80	30	38	25	160
11080000	8	155	160	100	33	44	20	180
11090000	9	175	185	115	38	49		350
11100000	10	190	195	120	41	52		440
11110000	11	210	215	130	46	60		520
11120000	12	245	250	145	52	65		730
11140000	14	260	290	155	60	72		1100
11170000	17	310	370	190	70	84		1600
11190000	19	350	420	230	81	119		2750
11220000	22	395	480	255	92	130		3650
11240000	24	430	540	280	105	145		4400
11260000	26	450	580	285	120	155		4700

Tolerance: Forged parts ± 5%

19-05-2015

GENERAL

Material : Mild steel
 Finish : Galvanized
 Temperature range : -4°F up to +392°F
 Standard certification : Certificate of Conformity

Suitable for wire rope
 Non-standard sizes or custom products available on request

SHACKLES

THIMBLES

SOCKETS

LINKS

SWIVELS

HOOKS

MOORING

OTHERS

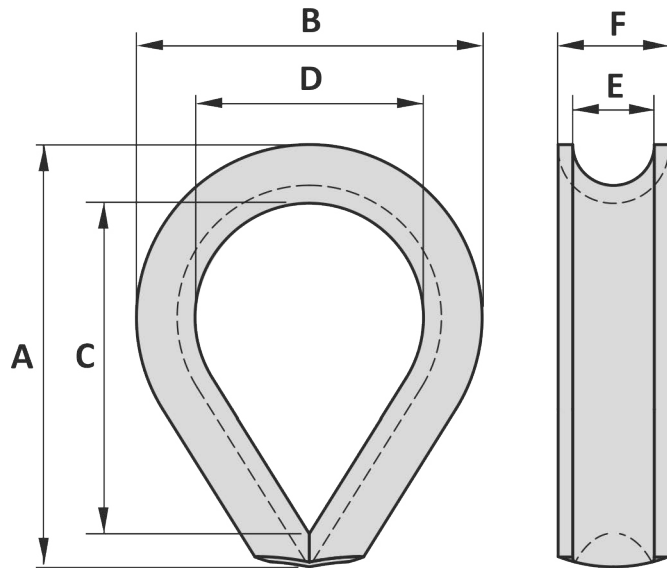

Art. No.	A inch	B inch	C inch	D inch	E inch	F inch	Packing	Weight lbs/100
11020000	2	1 2½/2	1 ¾/8	7/8	1½/2	9/16	600	18
11025000	2.5	1 3½/2	1 25/32	1 3/16	7/16	5/8	400	22
11030000	3	1 3½/2	2 5/32	1 3/8	½	23/32	300	44
11035000	3.5	2 7/8	2 9/16	1 25/32	19/32	25/32	150	57
11040000	4	2 15/16	2 15/16	1 31/32	1¼/16	7/8	150	79
11045000	4.5	3 1½/2	3 5/32	2 3/32	¾/4	1	75	110
11050000	5	3 15/16	3 9/16	2 3/8	13/16	1 1/8	75	132
11055000	5.5	4 5/16	3 ¾/4	2 9/16	29/32	1 3/16	40	154
11060000	6	4 17/32	4 23/32	2 ¾/4	1	1 11/32	40	220
11070000	7	5 5/16	5 ½/2	3 5/32	1 3/16	1 ½	25	353
11080000	8	6 5/32	6 5/16	3 15/16	1 5/16	1 ¾/4	20	397
11090000	9	6 7/8	7 7/32	4 17/32	1 ½	1 15/16		772
11100000	10	7 15/32	7 11/16	4 23/32	1 5/8	2 1/16		970
11110000	11	8 ¼/4	8 15/32	5 5/8	1 13/16	2 3/8		1146
11120000	12	9 21/32	9 27/32	5 23/32	2 1/16	2 9/16		1609
11140000	14	10 ¼/4	11 13/32	6 3/32	2 3/8	2 27/32		2425
11170000	17	12 3/16	14 9/16	7 15/32	2 ¾/4	3 5/16		3527
11190000	19	13 25/32	16 7/32	9 1/16	3 3/16	4 11/16		6063
11220000	22	15 9/16	18 29/32	10 ½/2	3 5/8	5 1/8		8047
11240000	24	16 15/16	21 ¼/4	11 1/32	4 1/8	5 23/32		9700
11260000	26	17 23/32	22 27/32	11 7/32	4 23/32	6 3/2		10362

Tolerance: Forged parts ± 5%

19-05-2015

Material : Mild steel
 Finish : Galvanized
 Temperature range : -20°C up to +200°C
 Standard certification : Certificate of Conformity

Suitable for wire rope
 Non-standard sizes or custom products available on request

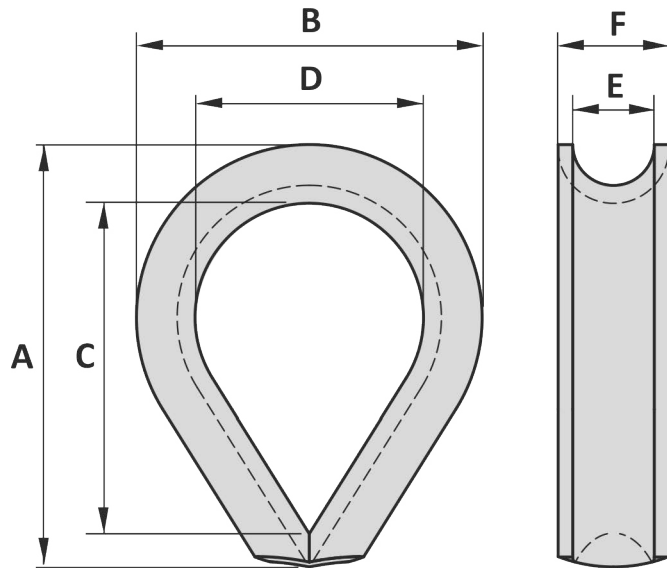

Art. No.	A inch	B mm	C mm	D mm	E mm	F mm	Packing	Weight kg/100
11020000	2	42	35	22	9	14	600	8.2
11025000	2.5	50	45	30	11	16	400	10
11030000	3	50	55	35	13	18	300	20
11035000	3.5	73	65	45	15	20	150	26
11040000	4	75	75	50	17	22	150	36
11045000	4.5	85	80	53	19	25	75	50
11050000	5	100	90	60	21	29	75	60
11055000	5.5	110	95	65	23	33	40	70
11060000	6	115	120	70	25	34	40	100
11070000	7	135	140	80	30	38	25	160
11080000	8	155	160	100	33	44	20	180
11090000	9	175	185	115	38	49		350
11100000	10	190	195	120	41	52		440
11110000	11	210	215	130	46	60		520
11120000	12	245	250	145	52	65		730
11140000	14	260	290	155	60	72		1100
11170000	17	310	370	190	70	84		1600
11190000	19	350	420	230	81	119		2750
11220000	22	395	480	255	92	130		3650
11240000	24	430	540	280	105	145		4400
11260000	26	450	580	285	120	155		4700

Tolerance: Forged parts ± 5%

19-05-2015

Material : Mild steel
 Finish : Galvanized
 Temperature range : -20°C up to +200°C
 Standard certification : Certificate of Conformity

Suitable for wire rope
 Non-standard sizes or custom products available on request

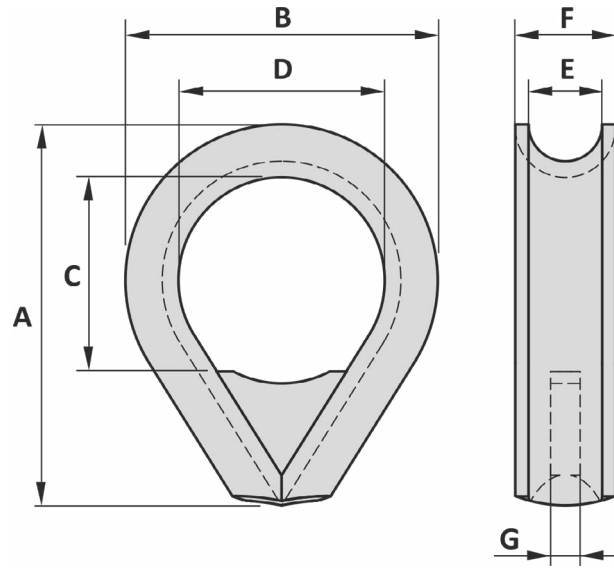

Art. No.	A inch	B mm	C mm	D mm	E mm	F mm	G mm	Packing	Weight kg/100
11040999	4	75	50	50	17	22	6	10	40
11045999	4 ½	85	50	53	19	25	6	10	50
11050999	5	100	60	60	21	29	8	10	80
11055999	5 ½	110	60	65	23	33	8	10	90
11069999	6	115	70	70	25	34	8	10	100
11079999	7	135	75	80	30	38	10	10	170
11089999	8	155	80	100	33	44	10	10	250
11099999	9	175	110	115	38	49	10	10	400
11109999	10	190	120	120	41	52	15	10	450
11119999	11	210	120	130	46	60	15	10	700
11129999	12	245	140	145	52	65	15	10	830
11149999	14	260	155	155	60	72	20	10	1250
11179999	17	310	200	190	70	84	20	10	1800
11199999	19	350	235	230	81	119	20	10	3050
11229999	22	395	240	255	92	130	20	10	4050
11249999	24	430	275	280	105	145	25	10	4950
11269999	26	450	295	285	120	155	30	10	5400

Tolerance: Forged parts ± 5%

Art. No.	A inch	B inch	C inch	D inch	E inch	F inch	G inch	Packing	Weight lbs/100
11040999	4	2 15/16	1 31/32	1 31/32	11/16	7/8	1/4	10	88
11045999	4 ½	3 11/32	1 31/32	2 3/32	3/4	1	1/4	10	110
11050999	5	3 15/16	2 3/8	2 3/8	13/16	1 1/8	5/16	10	176
11055999	5 ½	4 5/16	2 3/8	2 9/16	29/32	1 5/16	5/16	10	198
11069999	6	4 17/32	2 3/4	2 3/4	1	1 11/32	5/16	10	220
11079999	7	5 5/16	2 15/16	3 5/32	1 1/16	1 1/2	3/8	10	375
11089999	8	6 5/32	3 5/32	3 15/16	1 1/16	1 3/4	3/8	10	551
11099999	9	6 7/8	4 1/16	4 17/32	1 1/2	1 15/16	3/8	10	882
11109999	10	7 15/32	4 23/32	4 23/32	1 5/8	2 1/16	19/32	10	992
11119999	11	8 1/4	4 23/32	5 1/8	1 13/16	2 3/8	19/32	10	1543
11129999	12	9 21/32	5 1/2	5 23/32	2 1/16	2 9/16	19/32	10	1830
11149999	14	10 1/4	6 3/32	6 3/32	2 3/8	2 27/32	25/32	10	2756
11179999	17	12 3/16	7 7/8	7 15/32	2 3/4	3 5/16	25/32	10	3968
11199999	19	13 25/32	9 1/4	9 1/16	3 3/16	4 11/16	25/32	10	6724
11229999	22	15 9/16	9 7/16	10 1/32	3 5/8	5 1/8	25/32	10	8929
11249999	24	16 15/16	10 13/16	11 1/32	4 1/8	5 23/32	1	10	10913
11269999	26	17 23/32	11 1/8	11 1/32	4 29/32	6 3/32	1 1/16	10	11905

Tolerance: Forged parts ± 5%

GENERAL
SHACKLES
THIMBLES
SOCKETS
LINKS
SWIVELS
HOOKS
MOORING
OTHERS

Material : Cast steel
 Finish : Self colored
 Temperature range : -20°C up to +200°C
 Standard certification : Certificate of Conformity

*Subsurface blowholes can occur on the inside of a cast and are usually not visible until machining.
 Blowholes can be caused by air entrained in the melt, steam or smoke from the casting sand or other gases from the melt or mould, but does not affect the quality of the steel.*

Suitable for wire rope

Special holes for fittings or holes with (bronze) bushes on request

Maximum hole diameter for special hole is H max

Maximum inside diameter for (bronze) bushes is I max

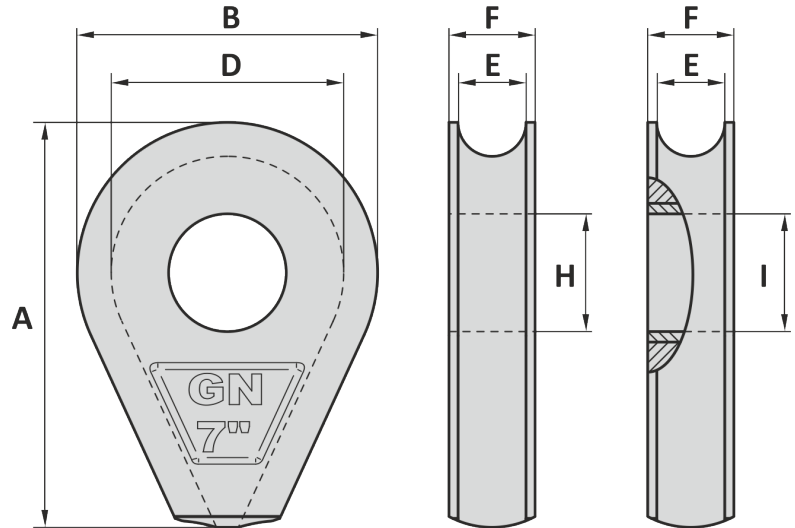

For the correct article number fill in the hole diameter in mm on the grey and underscored numbers

Art. No.	Size inch	Rope size mm	A mm	B mm	D mm	E mm	F mm	H mm	H max mm	I max mm	Weight kg
16020000	2	7 - 8	66	40	31	9	15	14	20	10	0.16
16027500	2 ½	9 - 10	82	50	38	11	18	18	25	15	0.29
16030000	3	11 - 12	98	60	45	13	20	21	30	20	0.46
16035000	3 ½	13 - 15	114	70	53	16	24	25	35	25	0.72
16040400	4	16 - 18	110	75	58	19	26	30 / 40	45	35	0.79
16050450	5	19 - 21	130	92	65	23	30	30 / 40 / 45	50	40	1.3
16060550	6	22 - 24	150	110	82	26	33	30 / 40 / 45 / 55	60	50	2.1
16070600	7	25 - 30	180	127	96	32	40	30 / 40 / 52 / 60	70	60	3.6
16080700	8	31 - 33	200	140	100	35	43	30 / 42 / 55 / 70	75	65	4.4
16090100	9	34 - 37	225	160	122	39	47	50 / 70 / 90 / 100	100	80	6.2
16100100	10	38 - 40	250	170	127	43	57	50 / 70 / 100	105	85	9.1
16120105	12	41 - 51	305	210	160	54	69	60 / 80 / 105	120	100	17
16140110	14	52 - 57	355	240	181	61	80	75 / 110	140	120	26
16170122	17	58 - 64	431	290	230	68	92	85 / 122	160	140	46
16230130	24	65 - 83	597	387	310	88	114	130	200	180	101

Tolerance: ± 5%

Art. No.	Size inch	Rope size inch	A inch	B inch	D inch	E inch	F inch	H inch	H max inch	I max inch	Weight lbs
16020000	2	¾ - 5/16	2 19/32	1 9/16	1 7/32	1 1/32	1 9/32	9/16	25/32	3/8	0.35
16027500	2 ½	1 1/2 - 3/8	3 7/32	1 31/32	1 1/2	7/16	23/32	23/32	1	19/32	0.64
16030000	3	7/16 - 15/32	3 7/8	2 3/8	1 29/32	1/2	25/32	13/16	1 3/16	25/32	1.0
16035000	3 ½	1/2 - 19/32	4 1/2	2 3/4	2 3/32	5/8	15/16	1	1 3/8	1	1.6
16040400	4	5/8 - 23/32	4 5/16	2 15/16	2 9/32	3/4	1 1/32	1 3/16 / 1 1/16	1 29/32	1 3/8	1.7
16050450	5	3/4 - 13/16	5 1/8	3 5/8	2 9/16	29/32	1 3/16	1 3/16 / 1 1/16 / 1 25/32	1 31/32	1 1/16	2.9
16060550	6	7/8 - 15/16	5 29/32	4 5/16	3 7/32	1 1/32	1 1/16	1 1/16 / 1 1/16 / 1 29/32 / 2 29/32	2 3/8	1 31/32	4.6
16070600	7	1 - 1 3/16	7 3/32	5	3 29/32	1 1/4	1 1/16	1 1/16 / 1 1/16 / 2 1/16 / 2 3/8	2 3/4	2 3/8	7.9
16080700	8	1 1/32 - 1 5/16	7 7/8	5 1/2	3 15/16	1 3/8	1 11/16	1 3/16 / 1 21/32 / 2 5/32 / 2 3/4	2 15/16	2 1/16	9.7
16090100	9	1 11/32 - 1 7/16	8 7/8	6 5/16	4 13/16	1 17/32	1 27/32	1 31/32 / 2 3/4 / 3 1/16 / 3 15/16	3 15/16	3 5/32	14
16100100	10	1 1/2 - 1 1/16	9 29/32	6 11/16	5	1 11/16	2 1/4	1 31/32 / 2 3/4 / 3 15/16	4 1/8	3 11/32	20
16120105	12	1 5/8 - 2	12	8 1/4	6 5/16	2 1/8	2 23/32	2 3/8 / 3 5/32 / 4 1/8	4 23/32	3 15/16	37
16140110	14	2 1/16 - 2 1/4	13 31/32	9 7/16	7 7/8	2 13/32	3 5/32	2 15/16 / 4 3/16	5 1/2	4 23/32	57
16170122	17	2 9/32 - 2 1/2	16 31/32	11 13/32	9 1/16	2 11/16	3 3/8	3 11/32 / 4 13/16	6 5/16	5 1/2	101
16230130	24	2 1/16 - 3 1/4	23 1/2	15 1/4	12 7/16	3 15/32	4 1/2	5 1/8	7 7/8	7 5/32	223

Tolerance: ± 5%

GENERAL
SHACKLES
THIMBLES
SOCKETS
LINKS
SWIVELS
HOOKS
MOORING
OTHERS

Material : Thimble: Mild steel
Link: Alloy steel
Finish : Painted
Temperature range : -20°C up to +200°C
Standard certification : Certificate of Conformity

Suitable for fibre rope
Special link or thimble on request

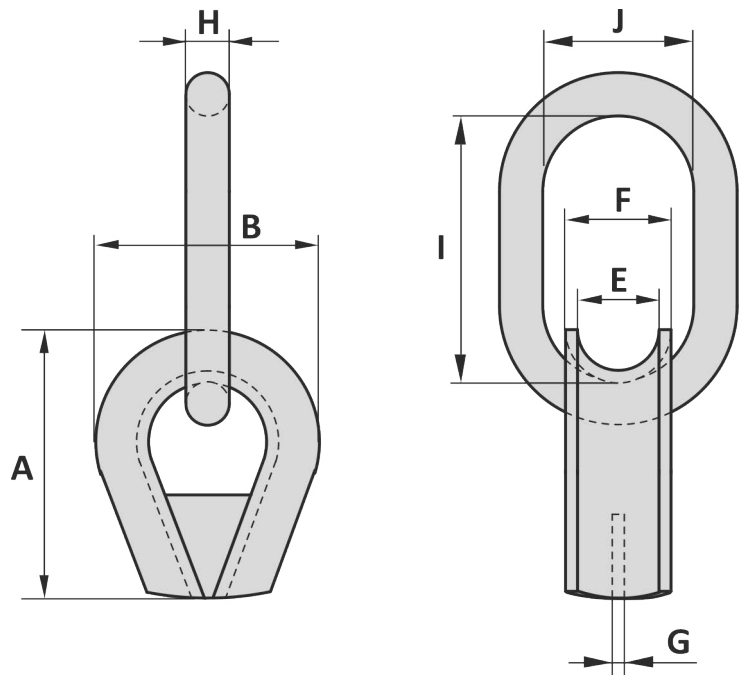

Art. No.	Rope size inch	MBL link ton	A mm	B mm	E mm	F mm	G mm	H mm	I mm	J mm	Weight kg
17090045	9 - 10 ½	104	385	300	100	130	20	45	340	180	35
17090051	9 - 10 ½	144	385	300	100	130	20	51	350	190	39
17090057	9 - 10 ½	188	385	300	100	130	20	57	400	200	46
17090063	9 - 10 ½	232	385	300	100	130	20	63	430	220	54
17125057	12 ½ - 13	188	470	320	115	155	20	57	400	200	56
17125063	12 ½ - 13	232	470	320	115	155	20	63	430	220	64
17125072	12 ½ - 13	336	470	320	115	155	20	72	460	250	77
17125080	12 ½ - 13	420	470	320	115	155	20	80	450	250	88
17140063	14 - 15	232	560	390	135	175	30	63	430	220	78
17140072	14 - 15	336	560	390	135	175	30	72	460	250	91
17140080	14 - 15	420	560	390	135	175	30	80	450	250	102
17160072	16 - 18	336	560	390	155	195	30	72	460	250	93
17160080	16 - 18	420	560	390	155	195	30	80	450	250	104
17160090	16 - 18	524	560	390	155	195	30	90	460	300	125
17190080	19 - 20	420	600	450	180	220	30	80	450	250	116
17190090	19 - 20	524	600	450	180	220	30	90	460	300	137
17190100	19 - 20	628	600	450	180	220	30	100	500	300	161
17210090	20 - 21	524	620	480	205	245	30	90	460	300	148
17210100	20 - 21	628	620	480	205	245	30	100	500	300	172
17210115	20 - 21	1000	620	480	205	245	30	115	600	400	234

Tolerance: ± 5%

28-11-2017

Material : Thimble: Mild steel
Link: Alloy steel
Finish : Painted
Temperature range : -4°F up to +392°F
Standard certification : Certificate of Conformity

Suitable for fibre rope
Special link or thimble on request

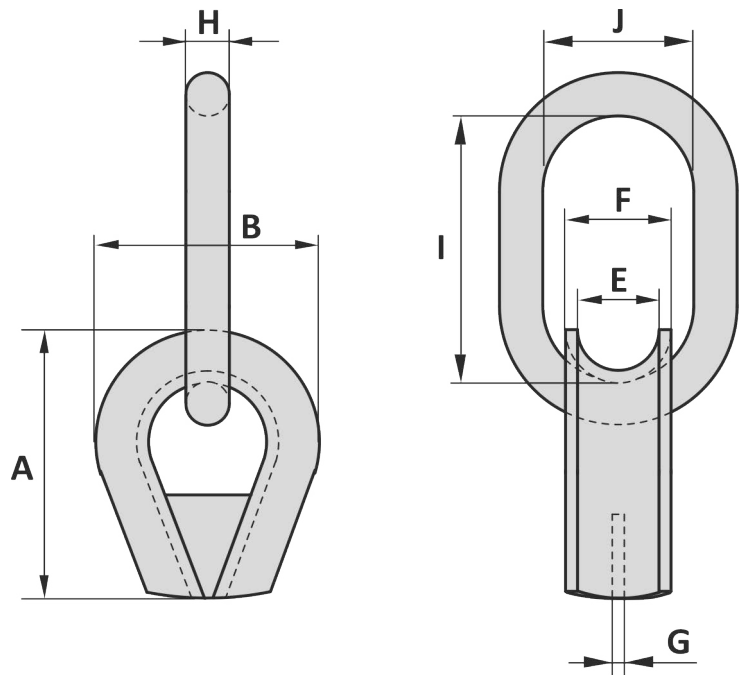

Art. No.	Rope size inch	MBL link ton	A inch	B inch	E inch	F inch	G inch	H inch	J inch	I inch	Weight lbs
17090045	9 - 10 1/2	104	15 5/32	11 13/16	3 15/16	5 7/8	25/32	1 25/32	13 3/8	7 3/32	77
17090051	9 - 10 1/2	144	15 5/32	11 13/16	3 15/16	5 7/8	25/32	2	13 25/32	7 15/32	86
17090057	9 - 10 1/2	188	15 5/32	11 13/16	3 15/16	5 7/8	25/32	2 1/4	15 3/4	7 7/8	101
17090063	9 - 10 1/2	232	15 5/32	11 13/16	3 15/16	5 7/8	25/32	2 15/32	16 15/16	8 21/32	119
17125057	12 1/2 - 13	188	18 1/2	12 19/32	4 17/32	6 3/32	25/32	2 1/4	15 3/4	7 7/8	123
17125063	12 1/2 - 13	232	18 1/2	12 19/32	4 17/32	6 3/32	25/32	2 15/32	16 15/16	8 21/32	141
17125072	12 1/2 - 13	336	18 1/2	12 19/32	4 17/32	6 3/32	25/32	2 27/32	18 1/8	9 27/32	170
17125080	12 1/2 - 13	420	18 1/2	12 19/32	4 17/32	6 3/32	25/32	3 3/32	17 23/32	9 27/32	194
17140063	14 - 15	232	22 1/16	15 11/32	5 5/16	6 7/8	1 3/16	2 15/32	16 15/16	8 21/32	172
17140072	14 - 15	336	22 1/16	15 11/32	5 5/16	6 7/8	1 3/16	2 27/32	18 1/8	9 27/32	201
17140080	14 - 15	420	22 1/16	15 11/32	5 5/16	6 7/8	1 3/16	3 3/32	17 23/32	9 27/32	225
17160072	16 - 18	336	22 1/16	15 11/32	6 3/32	7 11/16	1 3/16	2 27/32	18 1/8	9 27/32	205
17160080	16 - 18	420	22 1/16	15 11/32	6 3/32	7 11/16	1 3/16	3 3/32	17 23/32	9 27/32	229
17160090	16 - 18	524	22 1/16	15 11/32	6 3/32	7 11/16	1 3/16	2 27/32	18 1/8	11 13/16	276
17190080	19 - 20	420	23 3/8	17 23/32	7 3/32	8 21/32	1 3/16	3 5/32	17 23/32	9 27/32	256
17190090	19 - 20	524	23 3/8	17 23/32	7 3/32	8 21/32	1 3/16	3 9/16	18 1/8	11 13/16	302
17190100	19 - 20	628	23 3/8	17 23/32	7 3/32	8 21/32	1 3/16	3 5/32	19 11/16	11 13/16	355
17210090	20 - 21	524	24 13/32	18 29/32	8 1/16	9 21/32	1 3/16	3 9/16	18 1/8	11 13/16	326
17210100	20 - 21	628	24 13/32	18 29/32	8 1/16	9 21/32	1 3/16	3 11/16	19 11/16	11 13/16	379
17210115	20 - 21	1000	24 13/32	18 29/32	8 1/16	9 21/32	1 3/16	4 17/32	23 5/8	15 3/4	516

Tolerance: ± 5%

28-11-2017

GENERAL

Material : Alloy steel
 Finish : Painted
 Temperature range : -4°F up to +392°F
 Standard certification : Certificate of Conformity
 3.1 material certificate EN 10204

SHACKLES

Standard shackle with fishtail, shackle with D-handle or ring on request
 Suitable on all our type dee, bow and wide body shackles

THIMBLES

SOCKETS

LINKS

SWIVELS

HOOKS

MOORING

OTHERS

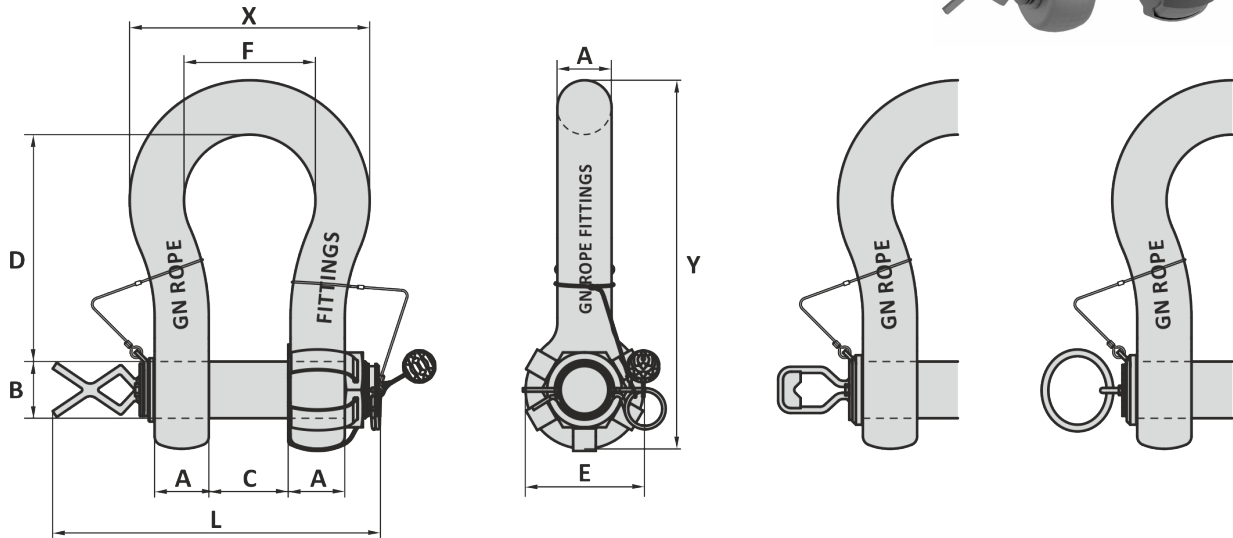

Art. No.	WLL ton	A inch	B inch	C inch	D inch	E inch	F inch	L inch	X inch	Y inch	Weight lbs
H9											
37000257	25	1 25/32	1 31/32	2 3/4	7	4 1/16	4 31/32	17 11/16	8 1/2	11 13/16	37
37000357	35	1 31/32	2 1/4	3 1/8	7 3/4	4 3/8	5 1/16	18 15/32	9 3/8	13 1/32	46
37000427	42.5	2 1/4	2 9/16	3 19/32	8 3/4	5 1/8	6 9/16	19 23/32	10 25/32	14 27/32	68
37000557	55	2 9/16	2 3/4	3 31/32	10 1/4	5 23/32	7 3/32	20 3/4	12 3/16	17 1/16	95
37000857	85	2 15/16	3 1/4	4 13/16	12 1/16	6 3/8	7 15/32	22 3/4	13 3/8	20 3/4	139
H10											
37001207	120	3 1/2	3 3/4	5 23/32	14 31/32	7 7/8	9 5/8	24 13/32	16 3/8	24 9/32	243
37001507	150	4	4 1/4	6 1/2	15 3/4	9 1/16	10 13/16	26 3/8	18 7/8	26 13/32	353
37002007	200	4 23/32	4 15/16	6 7/8	19 11/16	10 1/4	11 13/32	28 11/32	20 7/8	32	518
37002507	250	4 15/16	5 1/2	7 7/8	21 1/4	10 1/4	12	32 13/32	21 27/32	34 1/16	628
37003007	300	5 1/8	5 29/32	7 7/8	23 3/8	12	12	32 13/16	22 1/4	37 23/32	750
H10 SUPER											
38000404	40	1 25/32	1 31/32	2 3/4	7	4 1/16	4 31/32	17 19/32	8 1/2	11 13/16	35
38000554	55	2 1/4	2 1/4	3 1/8	7 3/4	4 3/8	5 1/16	19 1/8	9 15/16	13 7/16	55
37000854	85	2 3/4	2 3/4	3 31/32	10 1/4	5 5/8	7 3/32	20 3/4	12 19/32	17 3/16	99
37001104	120	3 3/32	3 1/4	4 13/16	12 15/16	6 3/8	7 15/32	22 1/16	13 25/32	20 15/16	154
37001404	150	3 9/16	3 3/4	5 1/8	14 31/32	7 7/8	9 1/16	23 13/16	16 17/32	24 1/8	243
37001754	175	4	4 1/4	5 5/16	15 3/4	9 1/16	9 25/32	25 11/32	17 23/32	26 11/32	331
37002004	200	4 23/32	4 3/4	6 7/8	19 11/16	10 1/4	11 13/32	28 11/32	20 7/8	31 15/16	496
37002504	250	4 15/16	5	8 15/32	20 15/32	10 1/4	12 13/16	30 3/16	22 5/8	33 1/32	661
37003004	300	5 5/16	6	8 15/32	19 11/16	12	13	33 25/32	24	34 3/32	776
H14											
36000047	40	1 25/32	2	3 5/32	7 7/8	4 9/32	5 1/2	17 13/16	9 5/8	13 1/32	51
36000057	55	2 9/16	2 3/16	3 19/32	9 27/32	5 5/8	6 9/16	19 11/16	11 11/32	15 3/4	90
36000077	75	2 15/16	2 3/4	4 1/8	11 13/16	5 29/32	7 3/32	21 7/16	13 5/32	19 3/32	128
36000127	125	3 11/32	3 5/32	5 5/16	14 9/16	6 1/2	8 29/32	23 7/16	15 11/32	22 15/16	203
36000157	150	3 9/16	3 3/4	5 23/32	15 3/4	7 7/8	9 27/32	24 13/32	16 7/8	25 1/8	254
36000207	200	4 1/8	4 1/8	6 3/32	18 29/32	8 3/8	10 13/16	26 3/8	19 1/16	29 23/32	403
36000257	250	4 23/32	4 23/32	6 7/8	21 29/32	9 7/16	11 13/16	28 11/32	21 1/4	33 15/32	562
36000307	300	5 1/2	5 5/32	7 15/32	23 3/8	11 15/32	13 25/32	33 3/16	24 23/32	37 5/32	811
36000407	400	6 1/16	6 1/16	8 7/8	24 15/32	13	14 1/16	36 1/8	27 1/8	40 3/4	1259

Tolerance: Inside length ± 7.5%, all other forged parts ± 5%, machined parts ± 1 mm

12-12-2023

Material : Alloy steel
 Finish : Painted
 Temperature range : -20°C up to +200°C
 Standard certification : Certificate of Conformity
 3.1 material certificate EN 10204

Standard shackle with fishtail, shackle with D-handle or ring on request
 Suitable on all our type dee, bow and wide body shackles

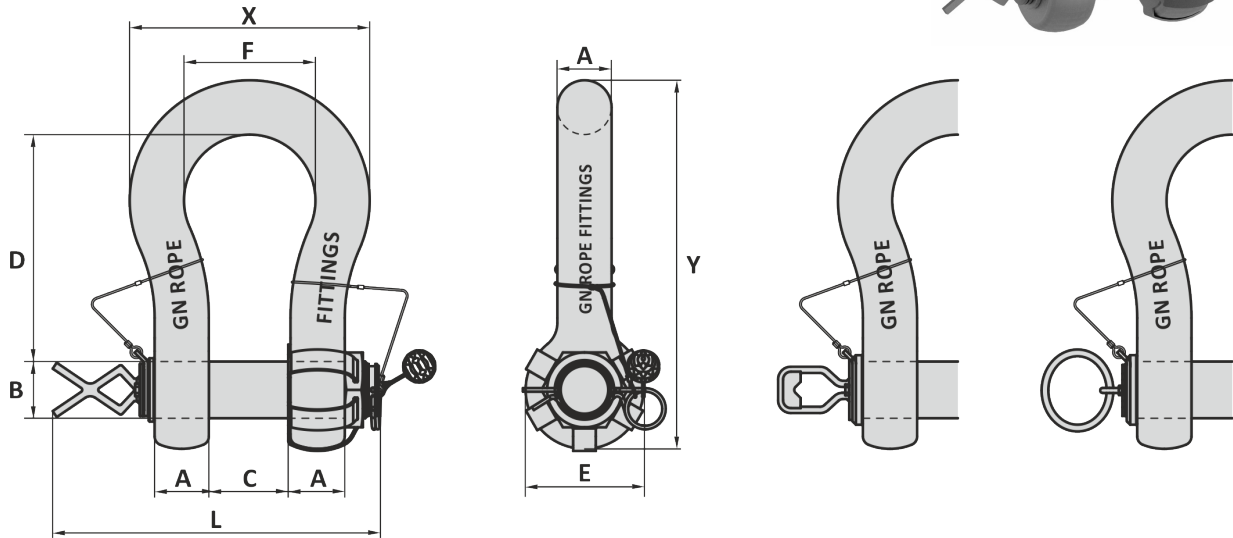

Art. No.	WLL ton	A mm	B mm	C mm	D mm	E mm	F mm	L mm	X mm	Y mm	Weight kg
H9											
37000257	25	45	50	70	178	103	126	449	216	300	17
37000357	35	50	57	79	197	111	138	469	238	331	21
37000427	42.5	57	65	91	222	130	160	501	274	377	31
37000557	55	65	70	101	260	145	180	527	310	433	43
37000857	85	75	83	122	329	162	190	578	340	527	63
H10											
37001207	120	89	95	145	380	200	238	620	416	617	110
37001507	150	102	108	165	400	230	275	670	479	671	160
37002007	200	120	125	175	500	260	290	720	530	813	235
37002507	250	125	140	200	540	260	305	823	555	865	285
37003007	300	130	150	200	600	305	305	833	565	958	340
H10 SUPER											
38000404	40	45	50	70	178	103	126	447	216	300	16
38000554	55	57	57	79	197	117	138	486	252	341	25
37000854	85	70	70	101	260	143	180	527	320	437	45
37001104	120	80	83	122	329	162	190	570	350	532	70
37001404	150	90	95	130	380	200	240	605	420	613	110
37001754	175	102	108	135	400	230	250	644	450	669	150
37002004	200	120	121	175	500	260	290	720	530	811	225
37002504	250	125	127	215	520	260	325	770	575	839	300
37003004	300	135	152	215	500	305	330	858	610	869	352
H14											
36000047	40	45	51	80	200	109	140	452	232	331	23
36000057	55	65	56	91	250	130	160	500	288	400	41
36000077	75	75	70	105	300	150	185	545	334	485	58
36000127	125	85	80	135	370	165	220	595	390	583	92
36000157	150	90	95	145	400	200	250	620	429	638	115
36000207	200	105	105	155	480	225	275	670	484	755	183
36000257	250	120	120	175	550	240	300	720	540	850	255
36000307	300	140	134	190	600	280	350	843	628	947	368
36000407	400	160	160	225	620	330	370	918	689	1035	571

Tolerance: Inside length ± 7.5%, all other forged parts ± 5%, machined parts ± 1 mm

12-12-2023

GENERAL
SHACKLES
THIMBLES
SOCKETS
LINKS
SWIVELS
HOOKS
MOORING
OTHERS

Material : Alloy steel
 Safety factor : ≤ 12914000 - 400 ton: 5 times
 > 12916000 - 400 ton: 4 times
 Standards : Generally according to EN 1677-4
 Finish : Painted
 Temperature range : ≤ 12914000 - 400 ton, -4°F up to +392°F
 > 12916000 - 400 ton, -40°F up to +392°F, Polar Rated
 Standard certification : Certificate of Conformity
 3.1 material certificate EN 10204

Non-standard sizes or custom products available on request

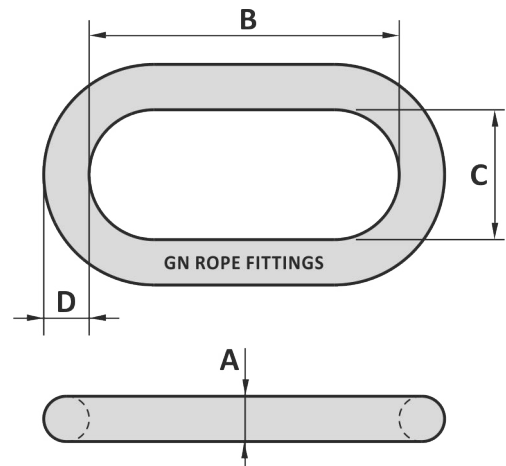

Art. No.	WLL ton	MBL ton	A inch	B inch	C inch	D inch	Weight lbs
12220000	5	25	3/8	6 5/16	3 9/16	3/8	3.3
12260000	8	40	1 1/32	7 3/32	3 15/16	1 1/32	5.1
12320000	10	50	1 1/4	7 7/8	4 5/16	1 1/4	8.6
12360000	16	80	1 13/32	10 1/4	5 1/2	1 13/32	14
12450000	26	130	1 25/32	13 3/8	7 3/32	1 25/32	29
12510000	36	180	2	13 25/32	7 15/32	2	37
12570000	47	235	2 1/4	15 3/4	7 7/8	2 1/4	53
12630000	58	290	2 15/32	16 15/16	8 21/32	2 15/32	71
12720000	84	420	2 27/32	18 1/8	9 27/32	2 27/32	99
12800000	105	525	3 5/32	17 23/32	9 27/32	3 5/32	123
12900000	131	655	3 9/16	18 1/8	11 13/16	3 9/16	170
12910000	157	785	3 15/16	19 11/16	11 13/16	3 15/16	223
12912500	250	1250	4 17/32	23 3/8	15 3/4	4 17/32	359
12912510	300	1500	4 17/32	23 3/8	11 13/16	4 17/32	340
12913500	400	2000	4 17/32	27 9/16	9 27/32	4 17/32	366
12914000	400	2000	4 17/32	19 5/32	9 27/32	4 17/32	291
12916000	400	1600	6 3/32	31 1/2	15 3/4	8 1/16	1058
12917000	500	2000	6 7/8	31 1/2	15 3/4	8 21/32	1329
12918000	600	2400	7 11/16	31 1/2	15 3/4	9 1/16	1614
12918100	700	2800	7 7/8	33 15/32	15 3/4	9 1/4	1753
12918200	800	3200	8 1/4	33 15/32	15 3/4	9 21/32	1942
12918300	900	3600	9 1/16	35 7/16	15 3/4	10 5/8	2467
12918400	1000	4000	9 7/16	35 7/16	15 3/4	11 1/32	2703
12918500	1250	5000	10 1/4	39 3/8	15 3/4	12 3/16	3481
12918600	1500	6000	10 3/4	39 3/8	15 3/4	12 19/32	3774

Tolerance: Forged parts ± 5%

14-06-2016

Material : Alloy steel
 Safety factor : ≤ 12914000 - 400 ton: 5 times
 > 12916000 - 400 ton: 4 times
 Standards : Generally according to EN 1677-4
 Finish : Painted
 Temperature range : ≤ 12914000 - 400 ton, -20°C up to +200°C
 > 12916000 - 400 ton, -40°C up to +200°C, Polar Rated
 Standard certification : Certificate of Conformity
 3.1 material certificate EN 10204

Non-standard sizes or custom products available on request

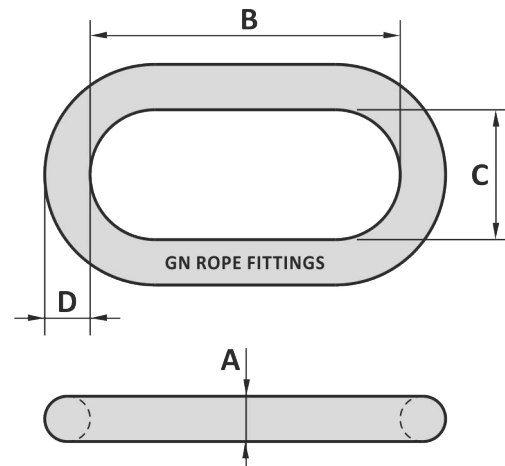

Art. No.	WLL ton	MBL ton	A mm	B mm	C mm	D mm	Weight kg
12220000	5	25	22	160	90	22	1.5
12260000	8	40	26	180	100	26	2.3
12320000	10	50	32	200	110	32	3.9
12360000	16	80	36	260	140	36	6.3
12450000	26	130	45	340	180	45	13
12510000	36	180	51	350	190	51	17
12570000	47	235	57	400	200	57	24
12630000	58	290	63	430	220	63	32
12720000	84	420	72	460	250	72	45
12800000	105	525	80	450	250	80	56
12900000	131	655	90	460	300	90	77
12910000	157	785	100	500	300	100	101
12912500	250	1250	115	600	400	115	163
12912510	300	1500	115	600	300	115	154
12913500	400	2000	115	700	250	115	166
12914000	400	2000	115	490	250	115	132
12916000	400	1600	155	800	400	205	480
12917000	500	2000	175	800	400	220	603
12918000	600	2400	195	800	400	230	732
12918100	700	2800	200	850	400	235	795
12918200	800	3200	210	850	400	245	881
12918300	900	3600	230	900	400	270	1119
12918400	1000	4000	240	900	400	280	1226
12918500	1250	5000	260	1000	400	310	1579
12918600	1500	6000	270	1000	400	320	1712

Tolerance: Forged parts ± 5%

14-06-2016

Material : Alloy steel
 Safety factor : ≤ 300 ton: 5 times
 > 300 ton: 4 times
 Standards : Generally according to EN 1677-4
 Finish : Painted
 Temperature range : -20°C up to +200°C
 Standard certification : Certificate of Conformity
 3.1 material certificate EN 10204

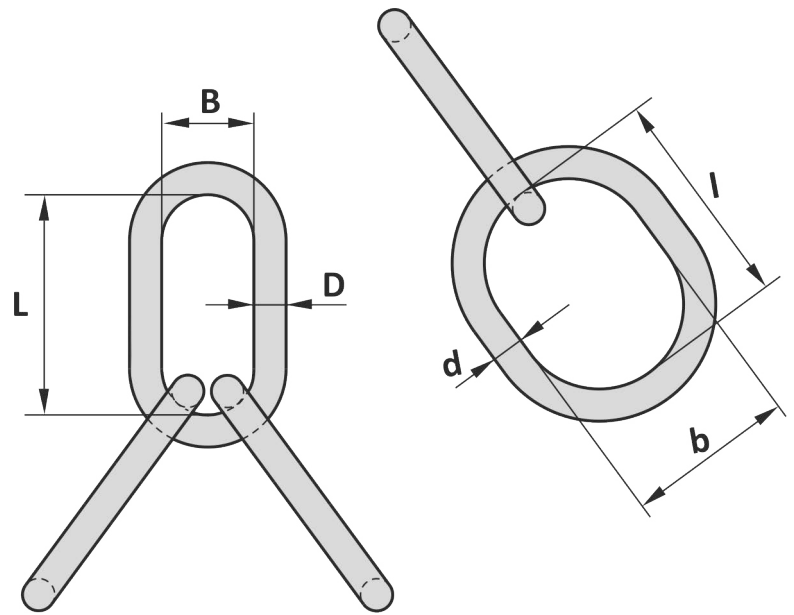
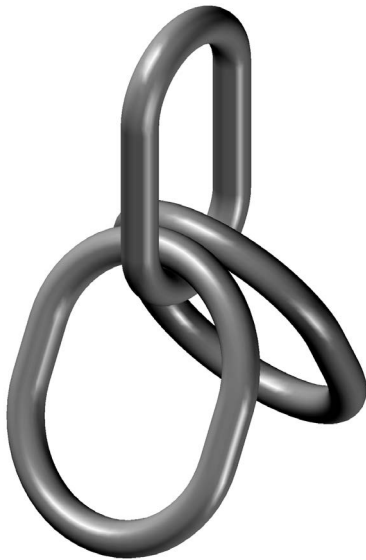

Art. No.	WLL ton	MBL ton	D mm	L mm	B mm	d mm	l mm	b mm	Weight kg
58000070	70	350	68	460	220	68	430	300	117
58000100	100	500	80	500	250	80	460	330	178
58000125	125	625	90	560	270	90	500	330	249
58000175	175	875	100	600	270	100	560	330	330
58000250	250	1250	115	600	400	115	600	400	505
58000300	300	1500	115	600	300	115	600	400	492
58000350	350	1400	115	600	270	115	600	400	480
58000400	400	1600	115	600	270	115	600	300	460

Tolerance: Forged parts ± 5%

Art. No.	WLL ton	MBL ton	D inch	L inch	B inch	d inch	l inch	b inch	Weight lbs
58000070	70	350	2 1/16	18 1/8	8 2/32	2 1/16	16 15/16	11 13/16	258
58000100	100	500	3 5/32	19 1/16	9 27/32	3 5/32	18 1/8	13	392
58000125	125	625	3 9/16	22 1/16	10 5/8	3 9/16	19 11/16	13	549
58000175	175	875	3 15/16	23 5/8	10 5/8	3 15/16	22 1/16	13	728
58000250	250	1250	4 17/32	23 3/8	15 3/4	4 17/32	23 5/8	15 3/4	1113
58000300	300	1500	4 17/32	23 3/8	11 13/16	4 17/32	23 5/8	15 3/4	1085
58000350	350	1400	4 17/32	23 3/8	10 5/8	4 17/32	23 5/8	15 3/4	1058
58000400	400	1600	4 17/32	23 3/8	10 5/8	4 17/32	23 5/8	11 13/16	1014

Tolerance: Forged parts ± 5%

18-03-2016

Material : High tensile steel
 Safety factor : 5 times
 Finish : Painted
 Temperature range : -40°C up to +200°C, Polar Rated
 Standard certification : Certificate of Conformity
 3.1 material certificate EN 10204

Non-standard sizes or custom products available on request

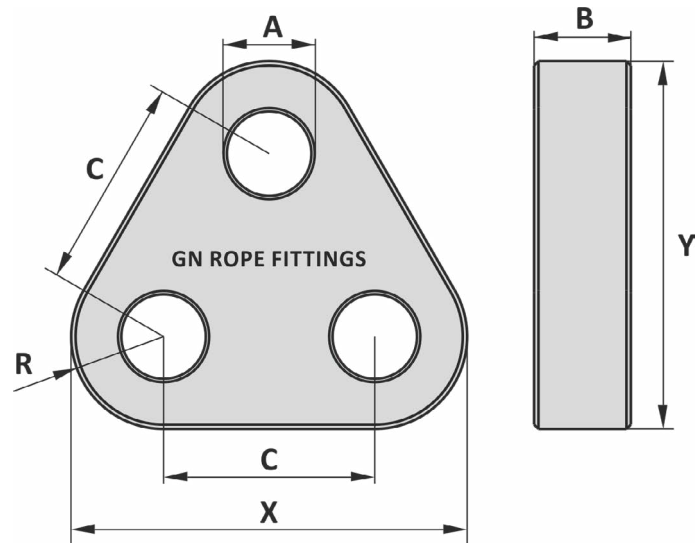
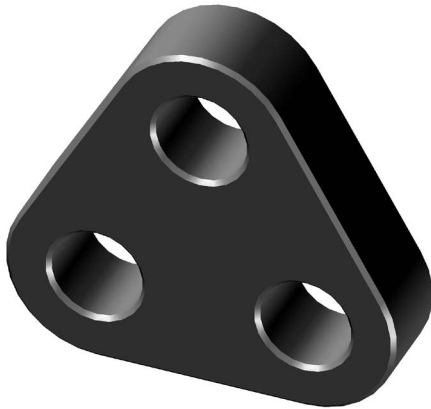

When there is a minimum distance between the triangle plate and the gap required, we advise to use washers.
 Spacers on the triangle plate available on request

Art. No.	WLL ton	MBL ton	A mm	B mm	C mm	R mm	X mm	Y mm	Weight kg
75001700	17	85	47	35	120	65	250	234	10
75002500	25	125	55	40	150	80	310	290	18
75003500	35	175	60	50	160	90	340	319	28
75005500	55	275	75	70	210	105	420	392	58
75008500	85	425	90	80	230	135	500	469	96
75012000	120	600	105	100	280	170	620	582	188
75015000	150	750	115	110	320	185	690	647	256
75017500	175	875	115	110	320	195	710	667	274
75020000	200	1000	140	120	390	215	820	768	390
75025000	250	1250	150	140	390	240	870	818	518
75030000	300	1500	160	150	420	250	920	864	617
75040000	400	2000	185	200	490	300	1090	1024	1170
75050000	500	2500	200	200	550	360	1270	1196	1619
75060000	600	3000	220	200	600	400	1400	1320	1972
75070000	700	3500	230	250	600	400	1400	1320	2452

Tolerance: Forged parts ± 5%, machined parts ± 1 mm

Art. No.	WLL ton	MBL ton	A inch	B inch	C inch	R inch	X inch	Y inch	Weight lbs
75001700	17	85	1 23/32	1 3/8	4 23/32	2 1/16	9 27/32	9 7/32	22
75002500	25	125	2 5/32	1 9/16	5 29/32	3 5/32	12 3/16	11 13/32	40
75003500	35	175	2 3/8	1 31/32	6 5/16	3 3/16	13 3/8	12 1/16	62
75005500	55	275	2 15/16	2 3/4	8 1/4	4 1/8	16 17/32	15 7/16	128
75008500	85	425	3 9/16	3 5/32	9 1/16	5 5/16	19 11/16	18 15/32	212
75012000	120	600	4 7/8	3 15/16	11 1/32	6 11/16	24 13/32	22 29/32	414
75015000	150	750	4 17/32	4 5/16	12 19/32	7 9/32	27 5/32	25 15/32	564
75017500	175	875	4 17/32	4 5/16	12 19/32	7 11/16	27 15/16	26 1/4	604
75020000	200	1000	5 1/2	4 23/32	15 11/32	8 15/32	32 9/32	30 1/4	860
75025000	250	1250	5 29/32	5 1/2	15 11/32	9 7/16	34 1/4	32 3/16	1142
75030000	300	1500	6 5/16	5 29/32	16 17/32	9 27/32	36 7/32	34	1360
75040000	400	2000	7 9/32	7 7/8	19 9/32	11 13/16	42 29/32	40 5/16	2579
75050000	500	2500	7 7/8	7 7/8	21 23/32	14 3/16	50	47 3/32	3569
75060000	600	3000	8 23/32	7 7/8	23 3/8	15 3/4	55 1/8	51 31/32	4348
75070000	700	3500	9 1/16	9 27/32	23 3/8	15 3/4	55 1/8	51 31/32	5406

Tolerance: Forged parts ± 5%, machined parts ± 1/32 inch

27-07-2015